

C3 Malvern Chronograph  
Forum Edition

Owner's handbook

**Christopher  
Ward**

## Time on your side...

Your Christopher Ward watch has been designed and engineered by highly talented craftspeople to ensure not only accurate and precise timekeeping but also to bring a real pride of ownership that only luxury items of the highest quality can ever hope to deliver.

You have made an investment, a good one, and the aim of this handbook is to help you make the most of that investment during what I hope will be a lifetime of ownership.



Christopher Ward

## Contents

C3 Malvern Chronograph Forum Edition	2
Technical information	3
How to operate your C3 Malvern Chronograph	4-14
Our watch care programme	15
Keeping in touch	16

## C3 Malvern Chronograph Forum Edition

**The culmination of numerous ideas and suggestions by its members (plus many more impressively Photoshopped images), the C3 Forum Limited Edition brings to life the most popular design as voted for by the CW Forum's members in 2017. Fully materialised, the results are mightily impressive.**

The seventh Forum Limited Edition created, and the first to be released after a year's hiatus, the C3 Malvern Chronograph Mk III provides a sound foundation upon which Forum members could build their own distinctive vision.

Although the case and Ronda 3520.D movement remain the same as the Mk III, there have been some bold changes. At its tip, the FLE's second hand is finished in red, while a unique blue and white subdial configuration epitomises the character and community of the Forum (and proves a useful exercise for prospective alternate C3 designs, too!).

Since its inception in 2005, the Forum has been a place for CW aficionados to sound off as well as an invaluable tool for all at CW to listen to customer feedback, whilst also helping inform future releases. An apt way of showing how the process can come full circle, the C3 Forum Limited Edition – a watch whose run is limited to just fifty pieces – showcases our thanks to the Forum for their continued support for the past twelve years. We're certain its pride of place is assured in any Forum member's collection.



## Technical information

### Features

- Swiss made
- Limited Edition of 50 pieces
- Quartz chronograph movement
- Steel case with brushed and polished sides
- Push-down crown with twin flag motif, two pushers to operate sub dial
- Anti-reflective double curve top sapphire crystal
- Domed Opalin dial with azzuré sub-dial details and sunray outer ring
- Date window revealing date disc
- Blued, brushed and polished hour and minute hands, with polished central second hands
- Snap case back with unique twin-flag engraving and serial number

- Italian hand-crafted oak leather quick-release strap with dress buckle, Italian hand-stitched Shell Cordovan quick-release strap with Bader deployment, or 'Milanese' mesh bracelet
- Luxurious presentation case and owner's handbook

### Technical

<b>Diameter:</b>	39mm
<b>Height:</b>	10.8mm
<b>Weight:</b>	46g
<b>Calibre:</b>	Ronda 3520.D
<b>Case:</b>	316L stainless steel
<b>Water Resistance:</b>	3 ATM (30 metres)
<b>Timing tolerance:</b>	-10/+20 secs per month
<b>Lug to lug:</b>	45.8mm
<b>Strap:</b>	20mm



## Setting the time/date

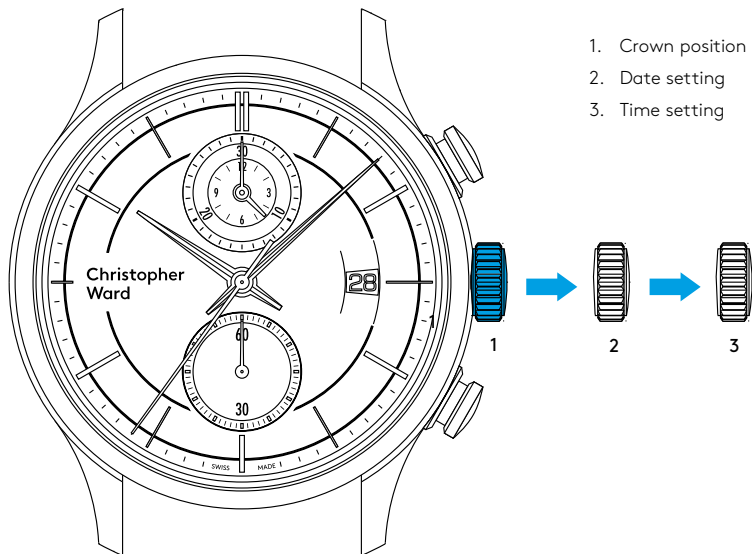

The crown should sit flush to the case (position 1) in order to maintain water resistance.

- For rapid date correction pull gently into position 2 and turn in an anti-clockwise direction.
- For setting the time pull gently into position 3 and turn clockwise to advance the time. For precise time setting it is recommended to pass beyond the desired minute and to set the hand backwards.
- Push the crown back to position 1.

**PLEASE NOTE:** Date correction should not be carried out between 20.00 hr and 02.00 hr as the watch gearing will already be aligning itself to change the date. The crown should always be pushed in after adjustment, and it is best to do so from position 3 to avoid advancing beyond the desired date.



## Timing functions

### Start

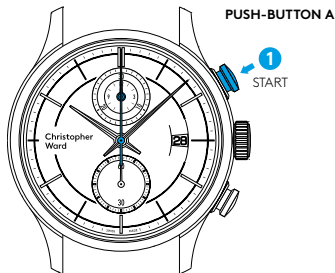

Before using the timing functions, please ensure that:

- The crown is in position 1
- The three chronograph hands (the hour/minute counter and the centre stop-second hand) are at zero position, as shown above.

To start timing press **push-button A**.

### Stop

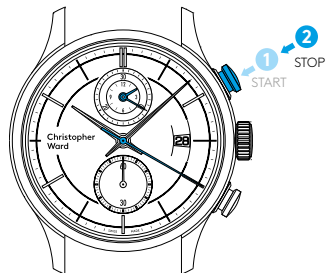

To stop the timing, press **push-button A** once more and read the three chronograph hands, for example: 2 hours/10 mins/20 seconds.

## Restart/Stop

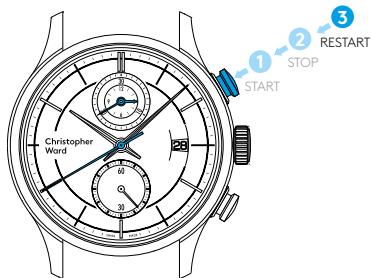

To restart the timing, press push-button **A** again (timing is resumed).

To stop timing press push-button **A** and read the 3 chronograph hands: 3 hours / 20 mins / 40 seconds.

## Reset

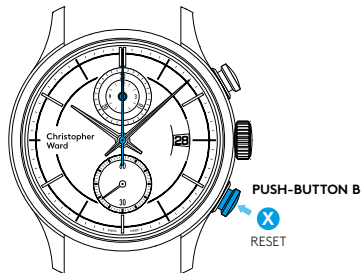

To reset the timing, press push-button **B** (The 3 chronograph hands will be reset to their zero positions).

## Adjusting chronograph hands to zero position

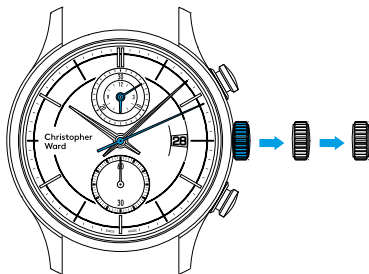

If one, or several, chronograph hands are not in their correct zero positions they will need to be adjusted:

- Pull the crown gently into position 3 (all three chronograph hands are in their correct or incorrect zero position) position.
- Keep push-buttons A and B depressed simultaneously for at least 2 seconds (the centre stop-second hand rotates by 360°, corrective mode is activated).

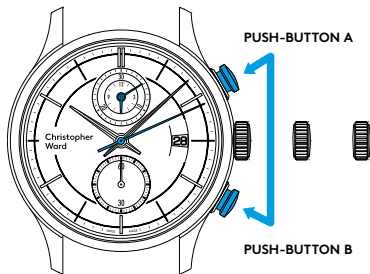

### Adjusting the centre stop second

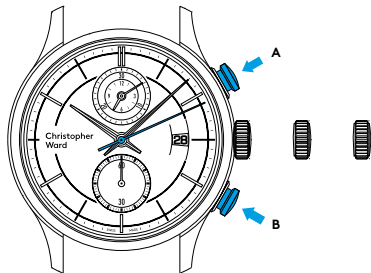

Single step	A	1 x short
Continuous	A	long

**When correct press push-button B to set.  
Corrective mode for the hour/minute counter  
is now activated.**

### Adjusting the hour/minute counter

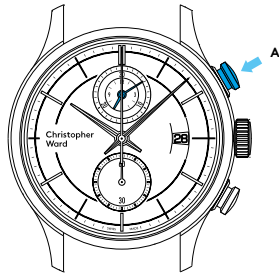

Single step	A	1 x short
Continuous	A	long

Once the 3 chronograph hands have been adjusted to their zero position, return the crown to position 1 (flush with the case). **Termination of the chronograph hands adjustment can be carried out at any time.**

## Straps and bracelets

As you would expect, we place as much emphasis on the quality of our straps and bracelets as we do our watches. We only use the finest leathers for our straps. Similarly, we only use the finest metals in the construction of our bracelets, all of which are precision engineered for durability, efficiency and comfort.

The following guidelines explain how easy it is to use and adjust your Christopher Ward strap or bracelet.

### Leather strap with Bader deployment

1.  
Press to release.

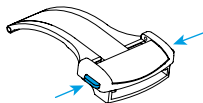

2.  
Pull open the clasp  
and locate the opening.

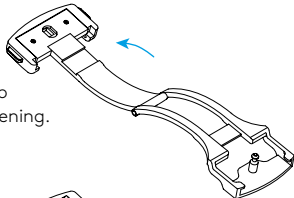

3.  
Thread the strap through  
the opening to the desired  
position. Close the clasp.

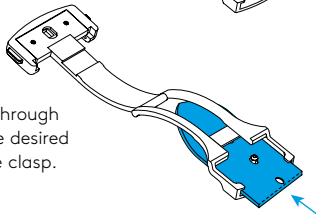

## Using the quick-release pins on your strap

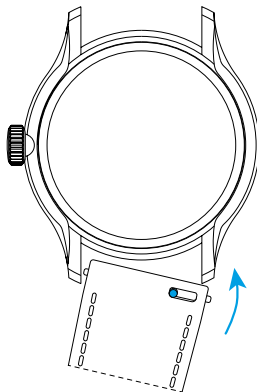
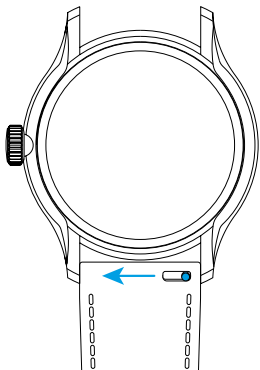

1. Locate the quick-release pin on your strap. Pull the pin to the side to detach your strap.
2. To reattach your strap, align the pins to the lug holes and click the strap into position. Repeat for the other side.

## Water resistance

Although your watch has been through vigorous static pressure testing, it is worth remembering that there are many variables that can affect the water resistance of your watch.

For instance, arm movements during swimming and the sudden impact of diving and water sports will drastically increase the pressure the watch is under. Wearing your watch in the bath, shower, or sauna can also have an effect as a rapid increase in temperature can cause seals to expand and in extreme cases, malfunction or create condensation.

For these reasons, the water resistance rating of your watch (as shown) should only ever be considered a guideline and we strongly recommend they are always adhered to.



### **1 ATM (10 metres)**

Safe to wear your watch while washing your hands with tap water.



### **3 ATM (30 metres)**

Washing your car and/or general hose pipe usage.



### **5 ATM (50 metres)**

Water resistant to most household shower units.



### **15 ATM (150 metres)**

Safe to use while snorkelling in open water.



### **30 ATM (300 metres)**

Ideal for experienced divers and those practising scuba-diving.



### **60 ATM (600 metres)**

Professional divers, experiencing prolonged exposure underwater.



### **100 ATM (1000 metres)**

Professional deep sea diving.

## Our watch care programme

Your watch is constructed from the finest components and materials available including one of Switzerland's finest mechanical movements. As with all watches of this quality, with the right care and attention, your new Christopher Ward watch has the potential to become an heirloom piece giving further joy to future generations. It's for this reason we have created our industry leading approach to after-sales care, starting with our famous 60|60 Guarantee which remains the most comprehensive guarantee in the world of watchmaking.

Visit our website for more details about our 60|60 Guarantee and Service and Repair Programme.

### **60|60 Guarantee**

#### **1. 60 Day free returns**

Our success depends on you being completely happy with your new Christopher Ward watch. You have up to 60 days to return your watch, absolutely free of charge, and receive a replacement or full refund by return – so long as it has not been worn and is returned in perfect condition.

#### **2. 60 Month movement guarantee**

Your watch, at its heart, has a top quality precision engineered Swiss movement – so it's very unlikely to give you problems with the minimum amount of care and attention, including a regular service. We recommend you return your watch to us every 3/4 years for a service, so our expert technicians can keep your fine timepiece in peak condition.

### **Servicing and repairs...the Christopher Ward way...**

Our innovative approach to servicing and repairing your Christopher Ward watch means that having your watch serviced or repaired doesn't mean months of waiting followed by an exorbitant bill – which is more or less the experience guaranteed by every other luxury watch brand. We have developed an easy, quick and affordable expert service and repairs programme that doesn't cost the earth and has your watch back where it belongs – on your wrist – in double-quick time.



## Keeping in touch with Christopher Ward

From small beginnings just a few short years ago (our first workshop was actually a refurbished chicken shed!), Christopher Ward has won a worldwide following for his eponymous watch brand and can justifiably claim to manufacture the most affordable luxury watches in the world.

For many, the philosophy behind the brand, of trying to put luxury watches within the reach of everyone, is as attractive as the watches themselves, as is the very open approach of the business which means that Chris and the team spend a lot of time communicating personally with our customers – many of whom have become friends.

As the owner of a Christopher Ward watch, if ever you need to get hold of us we are at your service. We have listed some useful contact details on the back cover.

There is also always something new going on at our website at **[www.christopherward.co.uk](http://www.christopherward.co.uk)** and, if you haven't already discovered the independent forum dedicated to our brand at **[www.christopherwardforum.com](http://www.christopherwardforum.com)** we would recommend a visit. Informative and fun, it's a great place to hear the unexpurgated view of Christopher Ward.



**Head Office**

1 Park Street, Maidenhead,  
Berkshire SL6 1SL  
United Kingdom

**Customer Services**

UK: +44 (0)1628 763040  
USA: +44 (0)1.877.226.8224  
[customerservices@christopherward.co.uk](mailto:customerservices@christopherward.co.uk)  
[technical@christopherward.co.uk](mailto:technical@christopherward.co.uk)

[christopherward.co.uk](http://christopherward.co.uk)