



C8 'Al Deere' TMB

Limited Edition

Owner's handbook

 Christopher
Ward

Time on your side...

Your Christopher Ward watch has been designed and engineered by experts to ensure not only precise timekeeping, but also to give you a sense of pride whenever you wear it.

You've made an investment, a good one, and the aim of this handbook is to help you make the most of it during what I hope will be a lifetime of ownership.



Christopher Ward

Contents

Alan Christopher 'Al' Deere	2-3
TMB Art Metal	4-5
C8 'Al Deere' TMB Limited Edition	6-7
Technical information	8-9
How to operate your C8 'Al Deere' TMB Limited Edition	10-14
Our watch care programme	15
Keeping in touch	16

Alan Christopher 'Al' Deere

Born in New Zealand in 1917, Alan Christopher 'Al' Deere is now recognised as one of the most successful and distinguished of all fighter pilots in the history of the RAF.

One of three brothers, the Deere family settled in Wanganui, a semi-rural town north of Wellington, where a chance encounter with a pilot landing his aircraft on a nearby beach saw Al determined to become one too. With New Zealand part of the Commonwealth, Deere later signed up to join the Royal Air Force, sailing to Britain in April 1937. He began his flight training at White Waltham – intriguingly, an airfield just two miles away from Christopher Ward's Maidenhead HQ – and was later confirmed as a pilot officer. He eventually joined RAF No.54 Squadron, a unit tasked with home defence.

Just ahead of the Battle of Britain, Supermarine Spitfire Mk 1 X4276 was delivered to No.54 Squadron.

After a maiden flight with the squadron commander, Squadron Leader James Leathart, Deere flew and claimed X4276 as his personal aircraft five days later. Also known as 'KIWI' in reference to Deere's heritage, X4276 was involved in an unfortunate accident on the 28th December 1940 when a pilot Deere was training, 20 year old Sergeant Harry Squire, collided with him midflight. Both pilots bailed out safely, and Deere's phrase, 'stick to me like glue', took on a particular irony.

Despite multiple bailouts and crash landings, Deere survived the Second World War and eventually rose to the prestigious ranking of Air Commodore. A man so indelibly linked to the RAF that he was chosen to lead a number of Battle of Britain pilots at Winston Churchill's funeral, Deere passed away in 1995. Fittingly, his ashes were scattered from a Spitfire over the River Thames during a Battle of Britain Memorial Flight.



a c. Deere

TMB Art Metal

We are always proud of the materials used throughout our watches. However, when our partners at TMB Art Metal get in touch, we know something very special is in the pipeline.

This is because TMB Art Metal specialises in sourcing and obtaining metals of historical significance. The brainchild of Christopher Bennett, who personally scours historical records to locate these metals, TMB Art Metal then incorporate them into items that further emphasise their story. Bennett can go to fantastic lengths to retrieve these artefacts; one excavation required a planning permit to dig up a Hawker Hurricane from underneath Buckingham Palace Road!

In the case of Al Deere's Spitfire X4276, or "KIWI", 47 years were to pass before it was excavated from its crash site in Kirklevington, North Yorkshire. Although a variety of parts from KIWI, including its cockpit controls, compass, instruments and propeller boss were salvaged, the C8 'Al Deere' TMB Limited Edition incorporates a piece of aluminium from its Rolls Royce Merlin engine. There's a neat symmetry that this piece of material – one that helped provide a place as iconic as the Spitfire its heartbeat – sits at the core of this watch too.





Actual metal from the Rolls Royce Merlin engine of Al Deere's excavated Spitfire. Sourced by the specialists at TMB Art Metal, the engine was melted down and formed into discs. The metal discs were then engraved and lacquer filled with Deere's famous advice, 'stick to me like glue' and takes pride of place behind museum-grade crystal in the backplate of the watch.



C8 'Al Deere' TMB Limited Edition

A 100-piece limited edition designed in Britain and hand-built in Christopher Ward's Swiss atelier to commemorate the 100th anniversary of the Royal Air Force, the C8 'Al Deere' TMB is a watch steeped in aviation history – in particular, the experiences of the RAF-revered Alan Christopher 'Al' Deere.

Most significantly, a piece of aluminium from the Rolls-Royce Merlin engine inside Deere's Spitfire, X2476 KL-B, has been secured by our partners at TMB Art Metal. Excavated in 1987, a cut and treated disc of engine metal – showcased through museum-grade sapphire crystal on the C8's reverse – has been engraved and lacquer filled with the famous advice Deere gave to his trainee, Sergeant Harry Squire: 'Stick to me like glue'.

Elsewhere, the dial recalls the Smiths Mk III clock found inside the Spitfire, with alternating Old Radium SuperLumiNova® numerals ensuring excellent legibility

in all lighting conditions. A nice touch of detail sits within the C8's small second subdial: a 'time of trip' message echoes the same view Deere would've encountered in X2476.

Inside, a hand-wound version of our Calibre SH21 movement offers 120 hours of chronometer-certified timekeeping, while the British design cues at its heart – the C8's crown references the Farnborough wind tunnels that helped sculpt the Spitfire's body – reflect the history and service of all those who have served throughout the RAF's ranks since its inception in 1918.





Technical information

Features

- Swiss made, special limited edition of 100 pieces
- 27 jewel in-house Calibre SH21 hand-wound movement with small seconds complication
- Disc of Supermarine Spitfire Mk 1 X4276 KL-B precious metal with Al Deere's "Stick to me like glue" quote engraving embedded below museum-grade sapphire into exhibition backplate
- 5 day (120 hour) power reserve
- Spitfire cockpit instrument-themed small second subdial at 6 o'clock
- Original Spitfire instrument panel inspired dial with Old Radium SuperLumiNova® markings
- Surgical-grade diamond-like carbon (DLC) sandblasted stainless steel case
- Sandblasted crown stamped with Farnborough wind tunnel profile
- Premium quality canvas webbing strap with CW

twin flag logo debossed in on reverse with black DLC sandblasted clasp

- Additional camel vintage oak leather strap included
- Unique engraved individual serial number
- Deluxe presentation case and owner's handbook with signed Certificate of Provenance

Technical

Diameter:	44mm
Height:	11.68mm
Weight:	81g
Calibre:	SH21 handwound Chronometer
Case:	316L stainless steel
Water Resistance:	5 ATM (50 metres)
Vibrations:	28,800 per hour (4Hz)
Timing tolerance:	-4/+6 secs per day
Lug to lug:	53.2mm
Strap:	22mm



Setting the time/date

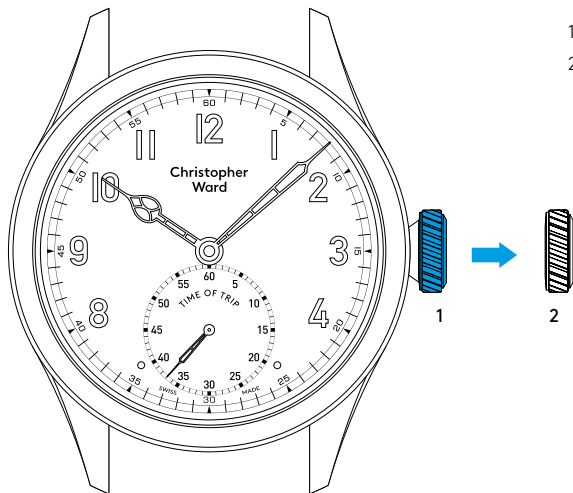

1. Manual winding
2. Time setting

The crown should sit flush to the case (position 1) in order to maintain water resistance. To re-power the watch after a period of non-use, simply wind the crown in a clockwise direction.

- For setting the time pull gently into position 2 and turn clockwise to advance the time. For precise time setting it is recommended to pass beyond the desired minute and to set the hand backwards.
- Push the crown back to position 1.

PLEASE NOTE: Take care not to overwind the crown past the point of resistance as it will damage the movement.

Using the quick-release pins on your strap

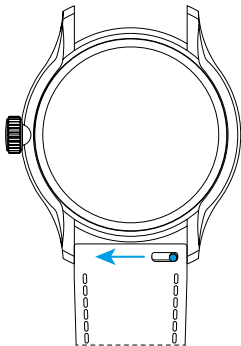

1. Locate the quick-release pin on your strap.
Pull the pin to the side to detach your strap.

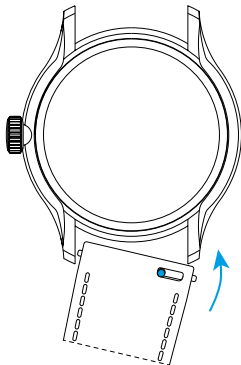

2. To reattach your strap, align the pins to the lug holes and click the strap into position.
Repeat for the other side.



METAL FROM MK 1 X427e KL-B

"STICK TO ME
LIKE GLUE"

Al' Deere
28.12.1940

ALAN CHRISTOPHER 'AL' DEERE - 54

SWISS MADE

72-5T

Water resistance

Although your watch has been through vigorous static pressure testing, it is worth remembering that there are many variables that can affect the water resistance of your watch.

For instance, arm movements during swimming and the sudden impact of diving and water sports will drastically increase the pressure the watch is under. Wearing your watch in the bath, shower, or sauna can also have an effect as a rapid increase in temperature can cause seals to expand and in extreme cases, malfunction or create condensation.

For these reasons, the water resistance rating of your watch (as shown) should only ever be considered a guideline and we strongly recommend they are always adhered to.



1 ATM (10 metres)

Safe to wear your watch while washing your hands with tap water.



3 ATM (30 metres)

Washing your car and/or general hose pipe usage.



5 ATM (50 metres)

Water resistant to most household shower units.



15 ATM (150 metres)

Safe to use while snorkelling in open water.



30 ATM (300 metres)

Ideal for experienced divers and those practising scuba-diving.



60 ATM (600 metres)

Professional divers, experiencing prolonged exposure underwater.



100 ATM (1000 metres)

Professional deep sea diving.

Our watch care programme

Your watch is constructed from the finest components and materials available including one of Switzerland's finest mechanical movements. As with all watches of this quality, with the right care and attention, your new Christopher Ward watch has the potential to become an heirloom piece giving further joy to future generations. It's for this reason we have created our industry leading approach to after-sales care, starting with our famous 60|60 Guarantee which remains the most comprehensive guarantee in the world of watchmaking.

Visit our website for more details about our 60|60 Guarantee and Service and Repair Programme.

60|60 Guarantee

1. 60 Day free returns

Our success depends on you being completely happy with your new Christopher Ward watch. You have up to 60 days to return your watch, absolutely free of charge, and receive a replacement or full refund by return – so long as it has not been worn and is returned in perfect condition.

2. 60 Month movement guarantee

Your watch, at its heart, has a top quality precision engineered Swiss movement – so it's very unlikely to give you problems with the minimum amount of care and attention, including a regular service. We recommend you return your watch to us every 3/4 years for a service, so our expert technicians can keep your fine timepiece in peak condition.

Servicing and repairs...the Christopher Ward way...

Our innovative approach to servicing and repairing your Christopher Ward watch means that having your watch serviced or repaired doesn't mean months of waiting followed by an exorbitant bill – which is more or less the experience guaranteed by every other luxury watch brand. We have developed an easy, quick and affordable expert service and repairs programme that doesn't cost the earth and has your watch back where it belongs – on your wrist – in double-quick time.

Keeping in touch with Christopher Ward

From small beginnings just a few short years ago (our first workshop was actually a refurbished chicken shed!), Christopher Ward has won a worldwide following for his eponymous watch brand and can justifiably claim to manufacture the most affordable luxury watches in the world.

For many, the philosophy behind the brand, of trying to put luxury watches within the reach of everyone, is as attractive as the watches themselves, as is the very open approach of the business which means that Chris and the team spend a lot of time communicating personally with our customers – many of whom have become friends.

As the owner of a Christopher Ward watch, if ever you need to get hold of us we are at your service. We have listed some useful contact details on the back cover.

There is also always something new going on at our website at **www.christopherward.co.uk** and, if you haven't already discovered the independent forum dedicated to our brand at **www.christopherwardforum.com** we would recommend a visit. Informative and fun, it's a great place to hear the unexpurgated view of Christopher Ward.

**Head Office**

1 Park Street, Maidenhead,
Berkshire SL6 1SL
United Kingdom

Customer Services

UK: +44 (0)1628 763040
USA: +44 (0)1.877.226.8224
customerservices@christopherward.co.uk
technical@christopherward.co.uk

christopherward.co.uk