

Emily Collection

OWNER'S HANDBOOK

Time on your side...

Your Christopher Ward watch has been designed and engineered by highly talented craftspeople to ensure not only accurate and precise timekeeping but also to bring a real pride of ownership that only luxury items of the highest quality can ever hope to deliver.

You have made an investment, a good one, and the aim of this handbook is to help you make the most of that investment during what I hope will be a lifetime of ownership.

A handwritten signature in black ink that reads "Chris". The letters are fluid and cursive, with a small dot above the 'i'.

Christopher Ward

Caring for your Christopher Ward quartz watch

Your Emily quartz watch is constructed from the finest components and materials available including one of Switzerland's finest quartz movements. As with all watches of this quality, with just a little care, it has the potential to become an heirloom piece giving further joy to future generations.

Here are a few hints to help keep your watch working perfectly over the years:

- Although the battery in your watch may last longer, we recommend you have it changed every 2/3 years by a reputable watch repairer.
- At the same time as having the battery changed it makes sense to have the watch repaired cleaned and lubricated. Our CW360° Watch Care Programme has been designed to make this easy, fast and affordable. You will find full details on our website.
- Adhere to the water resistance ratings towards the end of the handbook to prevent water getting to the movement which could result in a very costly repair or the need for a replacement movement.
- Your watch is shock resistant to minor impacts but dropping from height onto a hard surface may damage the movement.
- Should you need a replacement part - don't worry, we keep stocks of spare parts for years, even for discontinued models. It's all part of the Christopher Ward service.

Finally, don't forget our CW360° Care Programme allows you to return your watch absolutely free, for any reason, and with no quibbles, for up to 60 days after purchase and we also guarantee your movement for up to 60 months, so long as it is regularly serviced. After all, why shouldn't you enjoy peace of mind as much as you enjoy your watch?



Emily

Features

Swiss Made

4 jewel Swiss quartz movement

Sapphire crystal with anti-reflective coating

Water resistant to 3 atm (30 metres)

Unique serial number

Screw back case

Technical Data

Width: 18mm

Height: 7.3mm

Weight: 53g

Case: 316L Stainless steel

Calibre: Ronda 751

Display and Control Functions

Display elements

Minute Hand

Hour hand

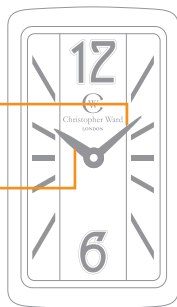

Control buttons

Crown

Setting the Time

From position ①, pull the crown to position ②, and adjust the time setting in either a clockwise or anti-clockwise direction

Return the crown to position ①, after adjustment to retain water resistance

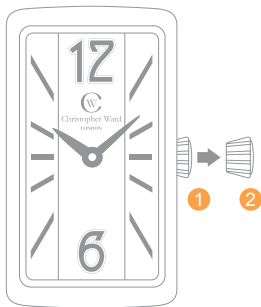

Water Resistance

Please note. these are only guidelines but we strongly urge you to adhere to them to retain the integrity of your watch. If you have any queries regarding this please contact us direct.

NB. To safeguard watch movement please ensure the crown is, at all times, screwed in correctly.



1 ATM
(10 Metres)

Safe to wear your watch while washing your hands with tap water



3 ATM
(30 Metres)

Washing your car and or general hosepipe usage



5 ATM
(50 Metres)

Water resistant to most household shower units



10 ATM
(100 Metres)

Safe to use while snorkelling in open water, it is not advisable to dive with your watch



30 ATM
(300 Metres)

Ideal for experienced divers and, in general, anybody practising scuba-diving



50 ATM
(500 Metres)

Professional divers, experienced prolonged exposure underwater

Keeping in touch with Christopher Ward

From small beginnings just a few short years ago (our first workshop was actually a refurbished chicken shed!), Christopher Ward has won a worldwide following for his eponymous watch brand and can justifiably claim to manufacture the most affordable luxury watches in the world.

For many, the philosophy behind the brand, trying to put luxury watches within the reach of everyone, is as attractive as the watches themselves as is the very open approach of the business which means that Chris and the team spend a lot of time communicating personally with customers - many of whom have become friends.

As the owner of a Christopher Ward watch, if ever you need to get hold of us we are at your service. We have listed some useful contact details on the back cover.

There is also always something new going on at our website at www.christopherward.co.uk and, if you haven't already discovered the independent forum dedicated to our brand at www.christopherwardforum.com we would recommend a visit. Informative and fun, it's a great place to hear the unexpurgated view of Christopher Ward of London!

CHR. WARD

christopherward.co.uk

Head Office

Christopher Ward (London) Limited, 1 Park Street, Maidenhead, Berkshire SL6 1SL United Kingdom

Telephone

+44 (0)1628 763040 (Head Office)

Customer Services

0844 875 1515 (UK) 1.877.226.8224 (USA)

Website

www.christopherward.co.uk (United Kingdom)

www.christopherward-usa.com (United States of America)

www.christopherward.eu (Europe)

General

customerservices@christopherward.co.uk

Technical

technical@christopherward.co.uk