

# C40 SpeedHawk™ Automatic Chronograph

O W N E R ' S      H A N D B O O K

## Time on your side...

Your Christopher Ward watch has been designed and engineered by highly talented craftspeople to ensure not only accurate and precise timekeeping but also to bring a real pride of ownership that only luxury items of the highest quality can ever hope to deliver.

You have made an investment, a good one, and the aim of this handbook is to help you make the most of that investment during what I hope will be a lifetime of ownership.

A handwritten signature in black ink, appearing to read 'Chris', with a stylized, cursive script.

Christopher Ward

# Caring for your Christopher Ward automatic watch

Your C40 SpeedHawk™ Automatic Chronograph is constructed from the finest components and materials available including one of Switzerland's finest automatic movements. As with all mechanical watches of this quality, with just a little care, it has the potential to become an heirloom piece giving further joy to future generations.

Here are a few hints to help keep your watch working perfectly over the years:

- Never fully wind your watch if it stops, 5-10 revolutions should suffice to have it restart.
- Try and wear your watch everyday, if possible, as this will both enable it to keep better time as well as preventing the lubricants in the movement from solidifying.
- Your watch is fitted with the finest Incabloc™ anti-shock system which should protect it if dropped onto a carpeted surface. However, it is best to avoid hard surfaces or sharp knocks. You may not want to wear your watch whilst playing racquet sports, for instance.
- There are many differing views about the right frequency for servicing your watch, ranging from 2 to 7 years! A modern mechanical watch like yours shouldn't need servicing more than every 4 years but we wouldn't recommend leaving it longer than this as, just like a car, the oil needs topping up from time to time.
- Always use a reputable watch repairer to clean and lubricate your watch.

Should you need a replacement part - don't worry, we keep stocks of spare parts for years, even for discontinued models. It's all part of the Christopher Ward service.

Finally, don't forget our famous **60:60 Guarantee** allows you to return your watch absolutely free, for any reason, and with no quibbles, for up to 60 days after purchase and we also guarantee your movement for up to 60 months.

After all, why shouldn't you enjoy peace of mind as much as you enjoy your watch?

**Your watch should also be thoroughly rinsed in fresh water after immersion in salt water.**

**You must always ensure the crown is fully tightened before any use in water.**



# The C40 SpeedHawk™ Automatic Chronograph

## Features

25 Jewel Swiss automatic chronograph  
Etachron regulator system  
3 counter multi-function chronograph (hours, minutes and stop second)  
Uni-directional rotating bezel and internal tachymeter  
Day / date calendar  
Convex sapphire crystal with anti-reflective coating  
Screw-in crown  
Water resistant to 50m (5 atm)  
Adjustable quick-release butterfly clasp  
Hand-polished surgical grade stainless steel case  
Unique serial number  
Luminous indices and hands  
Peregrine-shaped counterbalance  
Exhibition window

## Technical Data

Diameter:	42mm
Height:	16mm
Weight:	100g
Case:	316L Stainless steel
Calibre:	ETA 7750 Valjoux

# Description of the display and control buttons

## Display elements

Stop Second Hand

Minute Counter

Hour Hand

Second Counter

Hour Counter

Minute Hand

Day/Date Window  
(Dual language - French)

## Control buttons

Push-button A

Crown

Push-button B

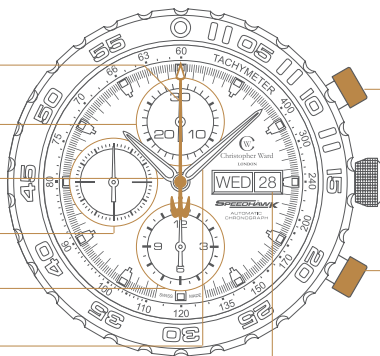

## Setting the time

For a superior water resistance your crown is of the screw-in type. To get to position ① turn the crown anti-clockwise until it releases itself.

- Pull out the crown to position ③ (the watch stops).
- Turn the crown until you reach the correct time e.g. **08.45 hr.**
- Push the crown back into position ① and screw the crown in a clockwise direction in order to maintain water resistance. The crown should sit flush to the case.

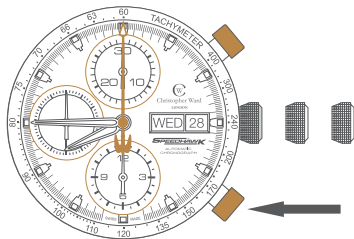
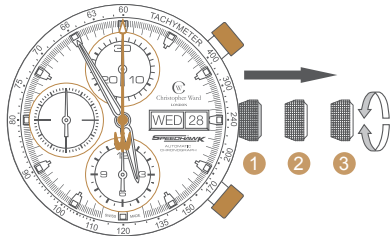



## Setting the day and date (quick mode)

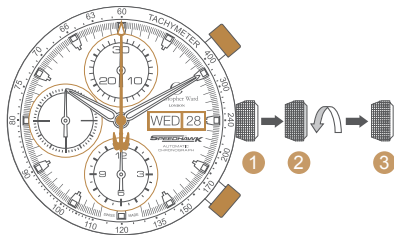

- Pull out the crown to position ② (the watch continues to run).
- Turn the crown clockwise until the correct date appears and anti-clockwise to set the day.
- Pull the crown to position ③

Push the crown back into position ① until flush with the case and screw in.

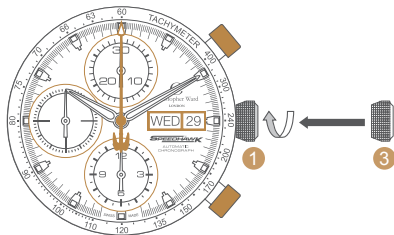

### **Please note:**

The date can not be changed during the date changing phase between 20.00 hr and 02.00 hr as the watch gearing will already be aligning itself to change the date.

The crown should always be screwed in after adjustment, and it is best to do so from position 3 to avoid advancing beyond the desired date.

# Setting the date/time

## Example:

Date / time on the watch: **Monday 28th** 01.25 hr

Present date / time: **Tuesday 4th** 20.30 hr

- Pull out the crown to position **2** (the watch continues to run).

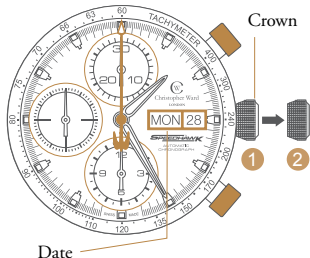

- Turn the crown clockwise until yesterday's date appears ie. **3rd**.
- Turn the crown anti-clockwise to change the day.

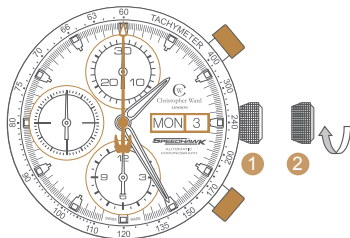

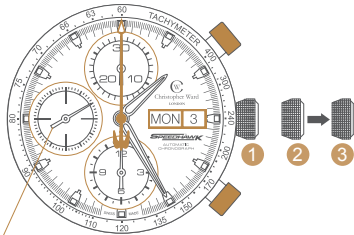

Second hand

- Pull out the crown to position **3** (the watch stops).

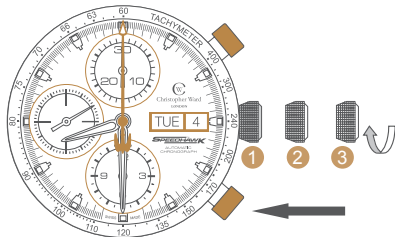

- Turn the crown clockwise until the correct date ie. **4th** appears (after passing through midnight).
- Continue to turn the crown until the correct time 20.30 hr appears.
- Push the crown back into position **1** until flush with the case and screw in.



# Chronograph:

- The **minute counter** measures 30 minutes per rotation.
- The **hour counter** measures 12 hours per rotation.

## Display elements

Minute Counter

Hour Counter

## Control buttons

Push-button A  
(Start / Stop)

Push-button B  
(Reset)

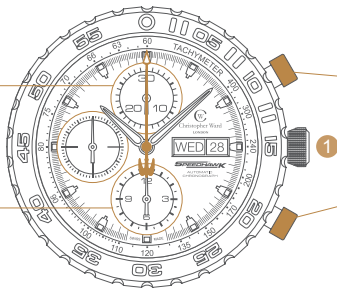

## Please note:

Before using the chronograph functions, please ensure that:

- The crown is in **position 1** (screwed in).
- The 2 chronograph hands are precisely at zero position following activation of **push-button B**.

Minute counter

Push-button A

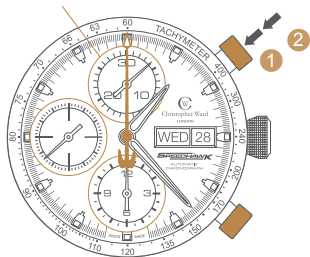

## Chronograph: Basic function

(Start / Stop / Reset)

### Example:

- ① **Start:** Press push-button A.
- ② **Stop:** to stop the timing, press push-button A once more and read the 2 chronograph counters: **4 min / 38 sec.**
- ③ **Zero positioning:** Press push-button B.  
(The 2 chronograph hands will be reset to their zero positions).

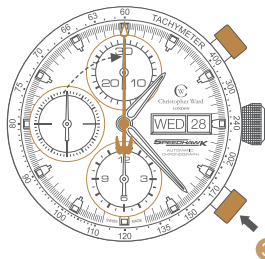

Push-button B

### Example of use:

Timing a runner over 100m.



# Using the tachymetric scale to calculate speed

**Example:** calculating the speed of a racecar over the course of a mile.

Record the time the racecar takes to cover a known distance of 1 mile.

Read off the speed on the tachymetric scale indicated by the central seconds hand. In this case, the racecar is travelling at 275mph.

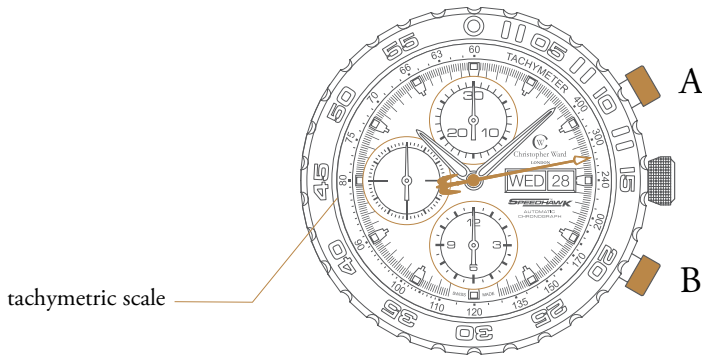



## Fitting the bracelet

If you find the bracelet needs adjusting to your wrist we recommend you have it re-sized by a reputable watch repairer or jeweller. Most local jewellers will either do this for free or perhaps make a nominal charge for what is a job that should only take a few minutes. It is always best to be present so a comfortable fit is achieved.

## Establishing the length of the bracelet

Place the watch with its separated bracelet on your wrist and estimate the number of links you need to remove. If you need to remove several links, try to keep the numbers removed from both halves of the bracelet as equal as possible to ensure that the clasp remains roughly in the middle of your wrist.

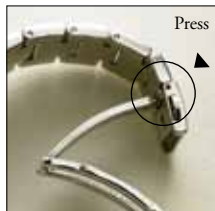

To open your bracelet simply press either side of the clasp to release as shown.

# The quick-release butterfly clasp

The strap versions of the C40 SpeedHawk™ Automatic Chronograph use quick-release butterfly clasps. If you are unfamiliar with the butterfly clasp system just follow our 8 step guide below.



**Step 1** Locate the clasp



**Step 2** Click quick-release



**Step 3** Pull open clasp



**Step 4** Prise cover open



**Step 5** Thread strap through



**Step 6** Snap back



**Step 7** Close clasp



**Step 8** Complete





**1 ATM** (10 Metres)

Safe to wear your watch while washing your hands with tap water.



**3 ATM** (30 Metres)

Washing your car and or general hosepipe usage.



**5 ATM** (50 Metres)

Water resistant to most household shower units.



**10 ATM** (100 Metres)

Safe to use while snorkelling in open water, it is not advisable to dive with your watch.



**30 ATM** (300 Metres)

Ideal for experienced divers and, in general, anybody practising scuba-diving.



**50 ATM** (500 Metres)

Professional divers, experienced prolonged exposure underwater.

## Water resistance

Please note. these are only guidelines but we strongly urge you to adhere to them to retain the integrity of your watch. If you have any queries regarding this please contact us direct.

**NB. To safeguard watch movement please ensure the crown is, at all times, screwed in correctly.**

## Keeping in touch with Christopher Ward...

From small beginnings just a few short years ago (our first workshop was actually a refurbished chicken shed!), Christopher Ward has won a worldwide following for his eponymous watch brand and can justifiably claim to manufacture the most affordable luxury watches in the world.

For many, the philosophy behind the brand, trying to put luxury watches within the reach of everyone, is as attractive as the watches themselves as is the very open approach of the business which means that Chris and the team spend a lot of time communicating personally with our customers - many of whom have become friends.

As the owner of a Christopher Ward watch, if ever you need to get hold of us we are at your service. We have listed some useful contact details on the back cover.

There is also always something new going on at our website at **[www.christopherward.co.uk](http://www.christopherward.co.uk)** and, if you haven't already discovered the independent forum dedicated to our brand at **[www.christopherwardforum.com](http://www.christopherwardforum.com)** we would recommend a visit. Informative and fun, it's a great place to hear the unexpurgated view of Christopher Ward of London!



Christopher Ward  
LONDON

Head Office. **Christopher Ward (London) Limited, 1 Park Street, Maidenhead  
Berkshire SL6 1SL, United Kingdom**

Telephone (Head Office). **+44 (0)1628 763040**

Customer Services. **0844 875 1515 (UK) 1.877.226.8224 (USA)**

Website. **[www.christopherward.co.uk](http://www.christopherward.co.uk)**

General. **[customerservices@christopherward.co.uk](mailto:customerservices@christopherward.co.uk)**

Technical. **[technical@christopherward.co.uk](mailto:technical@christopherward.co.uk)**