

# C9 PULSOMETER LIMITED EDITION CHRONOMETER

OWNER'S HANDBOOK

CHR. WARD  
L O N D O N

## TIME ON YOUR SIDE...

Your Christopher Ward watch has been designed and engineered by highly talented craftspeople to ensure not only accurate and precise timekeeping but also to bring a real pride of ownership that only luxury items of the highest quality can ever hope to deliver.

You have made an investment, a good one, and the aim of this handbook is to help you make the most of that investment during what I hope will be a lifetime of ownership.

A handwritten signature in black ink that reads "Chris". The script is fluid and cursive, with a large initial "C" and a small dot above the "i".

### CONTENTS

C9 PULSOMETER LE CHRONOMETER	2-5
TECHNICAL INFORMATION	6
HOW TO OPERATE YOUR FORUM LE	7-14
OUR WATCH CARE PROGRAMME	15
GENERAL INFORMATION	16



## C9 PULSOMETER LIMITED EDITION CHRONOMETER

English physician, Sir John Floyer (1649-1734) first introduced the practice of pulse rate measurement and asked clockmaker Samuel Watson to adapt a watch for this precise purpose some 300 years before smart phones and watches started to monitor our every function.

It was the early 20th Century, however, before the Pulsometer (sometimes called a Pulsograph) watch became widely used by the medical profession to measure a patient's heart beat rate and the C9 Pulsometer is the latest addition in the long tradition of these timepieces.

We have chosen not to go down the chronograph route for our first Pulsometer, instead choosing to use a COSC certified version of the self-winding Sellita SW200-1 as the movement, which guarantees accuracy to within -4 to +6 seconds a day. The beautifully engineered, 40mm C9 case, is constructed, rather aptly, of surgical grade

stainless steel and the SW200 movement can be seen working through the screw-down transparent back-plate.

The tachymeter style pulsometer scale of the dial is calibrated for 30 heart beats and both its red colour and the corresponding simplicity of the remainder of the dial make for especially easy reading. The watch has precision blued steel hour and minute hands but it is the hacking second hand, with its caduceus counter-balance design, that exemplifies the usual Christopher Ward attention to the fine details. In Greek mythology Asclepius represents medicine and healing, but it's Hermes staff, caduceus, which has become widely used as the symbol of medicine worldwide, and especially in North America.

Whether you are a member of the medical profession, or just think a fine mechanical watch that can help you monitor your health is a great idea, the C9 Pulsometer is a special watch made even more special as only 250 pieces will ever be released. It's enough to set one's pulse racing!

## THE COSC CERTIFIED CHRONOMETER

To gain chronometer status, watchmakers submit their Swiss movements to COSC, an independent, non-profit making watch accuracy verification organisation based in Geneva, to be tested against the international standards of ISO and DIN.

Certification follows exhaustive testing. In achieving the coveted status of Certified Chronometer, a movement must not only be made from the highest quality components, but also be the object of special care on part of the finest horologists and technicians as it is painstakingly assembled.

Only movements which meet the precision criteria are granted an official certificate. Each uncased movement is individually tested for fifteen days, in five positions, at three different temperatures.

Movements are fitted with a second hand for tests and measurements are made daily with the aid of cameras. Based on all of these measurements, seven eliminatory criteria are calculated, each of which must be met.

The exacting and rigorous nature of the COSC certification process means that the achievement of Certified Chronometer status is extremely rare. In fact, of all the watches produced in Switzerland each year, **just 3% bear the coveted COSC 'bulletin de marche'** or certificate of watch performance. Which is why, when you read the words 'Certified Chronometer' on a Swiss watch you can be sure that the movement behind the elegant dial is a rare example of fine Swiss watchmaking which is accurate, precise... **and extremely rare.**

Bulletin de marche  
Gangschein  
Boletín de marcha  
Watch rate certificate

CHRIS



SE DES CHRONOM

artz Genre IV  
Uhrenart IV  
zo Género IV

## TECHNICAL INFORMATION

### FEATURES

- Swiss made
- Limited edition of 250 pieces
- 26 jewel self-winding movement
- 38 hour power reserve
- COSC certified chronometer
- Hand finished, surgical grade, stainless steel case
- One-piece dial with 30 pulse measurement scale
- Blued steel central hour and minute hands
- Caduceus counter-balance central second design
- Date calendar at 3 o'clock
- Anti-reflective sapphire crystal
- Screw-in transparent case back
- Stop-second hacking mechanism

### TECHNICAL INFORMATION

Diameter:	40mm
Height:	11.35 mm
Calibre:	Sellita SW200-1 (COSC)
Vibrations:	28.800 vph
Case:	316L stainless steel
Water resistance:	5 BAR (50 METRES)
Strap width:	20mm
Dial Colour:	Optic White

## DISPLAY AND CONTROL BUTTONS

The C9 Pulsometer Limited Edition Chronometer has a maximum power reserve of 38 hours when fully wound. To re-power the watch after a period of non-use, simply pull out the crown and wind in approximately 20 revolutions. Normal wearing will very quickly allow the rotor to start re-powering the watch over time after putting it on your wrist.

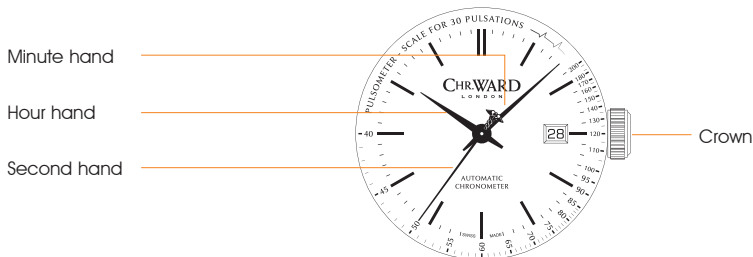



## SETTING THE TIME

- From position ①, pull the crown to position ② and adjust the calendar display in a clockwise direction.
- Pull the crown to position ③ and adjust the time setting in either a clockwise or anti-clockwise direction.
- After adjusting to the correct time ensure that the crown is flush with the case in order that water resistance is maintained.

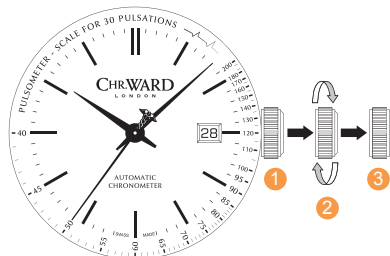

Please note: Date correction should not be carried out between 20.00 hrs and 02.00 hrs as the watch gearing will already be aligning itself to change the date. The crown should always be screwed in after adjustment, and it is best to do so from position 3 to avoid advancing beyond the desired date.



## WHAT IS A PULSOMETER?

The Pulsometer, also known as the Pulsograph is, ordinarily, a tool used by those in the medical profession to simplify the process of taking a pulse through a convenient scale marked on a watch.

With tachymeter style markings, the watch dial is graduated for a certain number of pulsations (as shown). The scale allows the direct reading of the rate without needing to do any multiplication in your head.

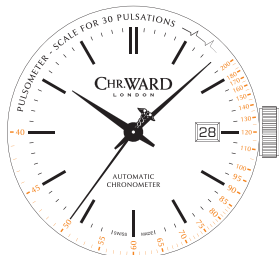

## READING YOUR PULSOMETER

- Wait for the second hand to align with 12.00 as shown on position ①.
- As the second hand sweeps clockwise start to take a pulse reading.
- After 30 pulses take a reading, see ② if 30 pulses take 22 seconds then the pulse rate is 80 beats per minute.

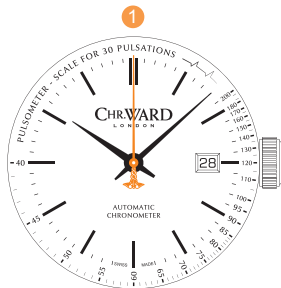



## STRAPS & BRACELETS

As you would expect, we place as much emphasis on the quality of our straps and bracelets as we do our watches. We only use the finest leathers for our straps. Similarly, we only use the finest metals in the construction of our bracelets, all of which are precision engineered for durability, efficiency and comfort. The following guidelines explain how easy it is to use and adjust your Christopher Ward strap.

### LEATHER STRAP WITH BADER DEPLOYMENT

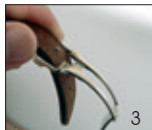

1. Press to release
2. Pull open the clasp
3. Locate the opening and thread the strap through
4. Close the clasp

## WATER RESISTANCE

Although your watch has been through vigorous static pressure testing, it is worth remembering that there are many variables that can affect the water resistance of your watch.

For instance, arm movements during swimming and the sudden impact of diving and water sports will drastically increase the pressure the watch is under. Wearing your watch in the bath, shower, or sauna can also have an effect as a rapid increase in temperature can cause seals to expand and in extreme cases, malfunction or create condensation.

For these reasons, the water resistance rating of your watch (as shown) **should only ever be considered a guideline** and we strongly recommend they are always adhered to.



### **1 BAR** (10 METRES)

Safe to wear your watch while washing your hands with tap water.



### **3 BAR** (30 METRES)

Washing your car and/or general hose pipe usage.



### **5 BAR** (50 METRES)

Water resistant to most household shower units.



### **10 BAR** (100 METRES)

Safe to use while snorkelling in open water.



### **30 BAR** (300 METRES)

Ideal for experienced divers and those practising scuba-diving.



### **50 BAR** (500 METRES)

Professional divers, experiencing prolonged exposure underwater.



### **100 BAR** (1000 METRES)

Professional deep sea diving.

## OUR WATCH CARE PROGRAMME

Your watch is constructed from the finest components and materials available including one of Switzerland's finest mechanical movements. As with all watches of this quality, with the right care and attention, your new Christopher Ward watch has the potential to become an heirloom piece giving further joy to future generations. It's for this reason we have created our industry leading approach to after-sales care, starting with our famous 60/60 Guarantee which remains the most comprehensive guarantee in the world of watchmaking.

Visit our website for more details about our 60/60 Guarantee and Service and Repair Programme.

Christopher Ward's 60/60 Guarantee is designed to deliver you complete peace of mind and the best support possible throughout the lifetime of your ownership. The guarantee has two key elements and sits alongside our Servicing and Repairs Programme:

### **60/60 GUARANTEE**

#### **1. 60 DAY FREE RETURNS**

Our success depends on you being completely happy with your new Christopher Ward watch. You have up to 60 days to return your watch, absolutely free of charge, and receive a replacement or full refund by return – so long as it has not been worn and is returned in box-perfect condition.

#### **2. 60 MONTH MOVEMENT GUARANTEE**

Your watch, at its heart, has a top quality precision engineered Swiss movement – so it's very unlikely to give you problems with the minimum amount of care and attention, including a regular service. We recommend you return your watch to us every 3/4 years for a service, so our expert technicians can keep your fine timepiece in the peak of condition.

### **SERVICING & REPAIRS...THE CHRISTOPHER WARD WAY...**

Our innovative approach to servicing and repairing your Christopher Ward watch means that having your watch serviced or repaired doesn't mean months of waiting followed by an exorbitant bill – which is pretty much the experience guaranteed by every other luxury watch brand. We have developed an easy, quick and affordable expert service and repairs programme that doesn't cost the earth and has your watch back where it belongs – on your wrist – in double-quick time.



## KEEPING IN TOUCH WITH CHRISTOPHER WARD

From small beginnings just a few short years ago (our first workshop was actually a refurbished chicken shed!), Christopher Ward has won a worldwide following for his eponymous watch brand and can justifiably claim to manufacture the most affordable luxury watches in the world.

For many, the philosophy behind the brand, of trying to put luxury watches within the reach of everyone, is as attractive as the watches themselves, as is the very open approach of the business which means that Chris and the team spend a lot of time communicating personally with our customers – many of whom have become friends.

As the owner of a Christopher Ward watch, if ever you need to get hold of us we are at your service. We have listed some useful contact details on the back cover.

There is also always something new going on at our website at **[www.christopherward.co.uk](http://www.christopherward.co.uk)** and, if you haven't already discovered the independent forum dedicated to our brand at **[www.christopherwardforum.com](http://www.christopherwardforum.com)** we would recommend a visit. Informative and fun, it's a great place to hear the unexpurgated view of Christopher Ward of London!

# CHR. WARD

L O N D O N

## HEAD OFFICE

Christopher Ward (London) Limited,  
1 Park Street, Maidenhead,  
Berkshire SL6 1SL United Kingdom  
+44 (0)1628 763040

## CUSTOMER SERVICES

UNITED KINGDOM: +44 (0)1628 763040  
UNITED STATES OF AMERICA: 1.877.226.8224  
[customerservices@christopherward.co.uk](mailto:customerservices@christopherward.co.uk)  
[technical@christopherward.co.uk](mailto:technical@christopherward.co.uk)

## WEBSITE

[www.christopherward.co.uk](http://www.christopherward.co.uk)  
[www.christopherward.com](http://www.christopherward.com)