

C1 Moonglow

Owner's Handbook



Time on your side

Your Christopher Ward watch has been designed in Britain and engineered in Switzerland by highly talented craftspeople. This ensures not only accurate and precise timekeeping, but also brings a real pride of ownership that only watches of the highest quality standards can hope to deliver.

You have made an investment, a good one, and the aim of this manual is to help you make the most of that investment in what we hope will be a lifetime of ownership.

Mike France
CEO & co-founder



C1 Moonglow

If there's a generalisation that rings true of moonphase watches, it's that they tend to conform to a particularly understated formula.

The C1 Moonglow is the antithesis of this. 50 years after Neil Armstrong first set foot on the Moon's dusty surface, the Moonglow offers a distinctively modern take on the most classical of watchmaking genres.

Most distinctive is the inclusion of two moons that perpetually circle around the Moonglow's dial. Powered by Calibre JJ04, Christopher Ward's in-house modification (could it be described as our own lunar module?), the position of the moon will remain unerringly accurate to a day every 128 years if kept wound.

Yet the most dramatic inclusion here is that of the premium-grade Grade X1 GL C1 Super-LumiNova® that coats the C1's moons, hands, indexes and date wheel; in particular, the latter feature replaces a conventional date window with an entire lumed ring visible around the outside of the dial, save for one non-lumed section that indicates the date when read against the numbers outside it.

A watch as innovative as the C1 Moonglow deserves the best possible lume to match; and like the pearly presence in the night's sky that has fascinated humankind for millennia, we hope you'll find the Moonglow just as enchanting.

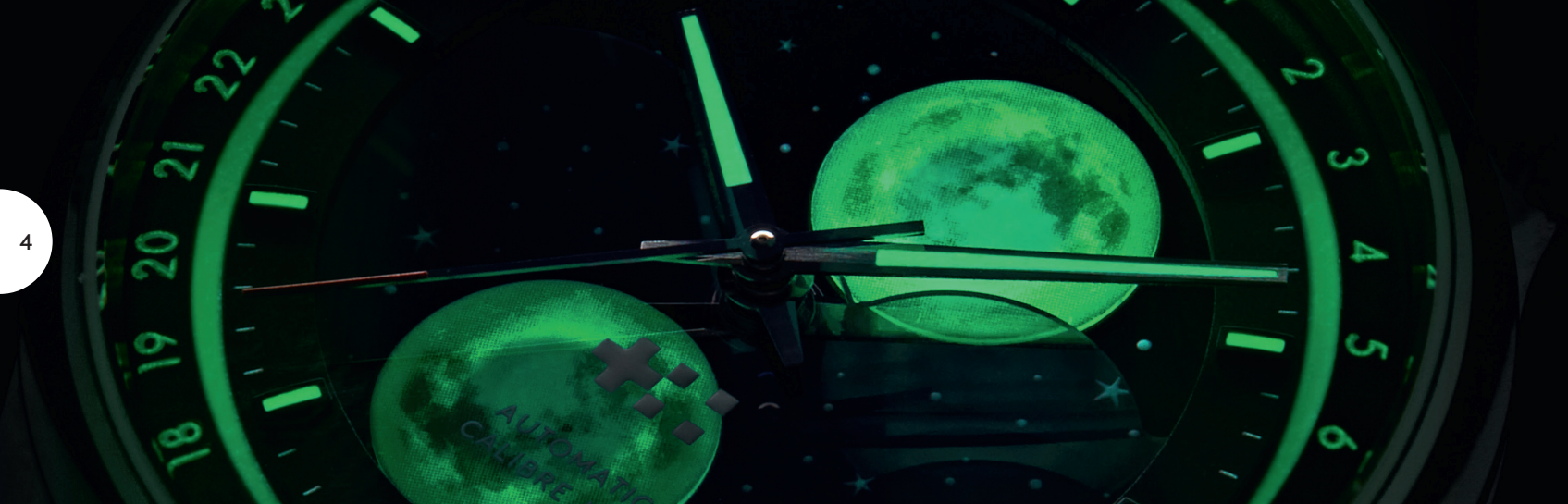

Display and control buttons

C1 Moonglow has a maximum power reserve of 38 hours when fully wound. To re-power the watch after a period of non-use, simply wind the crown in a clockwise direction for approximately 20 revolutions. Normal wearing will very quickly allow the rotor to start re-powering the watch over time after putting it on your wrist.

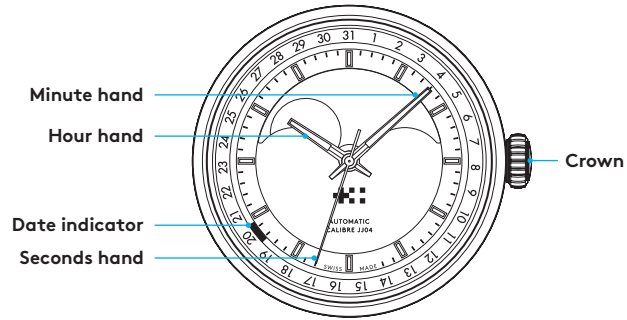

Features

- Swiss made
- Self-winding 26 jewel movement with 'JJ04' in-house Moonphase module
- 38 hour power reserve
- Lumed date ring with shaded section
- Black diamond-like carbon (DLC) finished rotor
- Brushed and polished marine-grade stainless steel case
- Anti-reflective domed sapphire crystal
- Push-down crown with twin flag motif
- Polished and smoked sapphire dial
- 3D-stamped luminescent Moonphase disc visible through unique wide and curved aperture
- Raised and polished indexes
- Brushed and polished steel hands
- Super-LumiNova Grade® X1 GL C1 moons, hands, indexes, numerals and outer date ring
- Exhibition backplate with unique engraved serial number
- Eco-friendly luxury presentation case and owner's handbook
- Italian hand-stitched Shell Cordovan quick-release strap with Bader deployment, or 'Milanese' mesh bracelet

Technical Information

Calibre	Sellita SW220 with 'JJ04' module
Case	316L stainless steel
Diameter	40.5mm
Height	12.35mm
Weight	61g
Water resistance	3 ATM (30 metres)
Vibrations	28,800 per hour (4Hz)
Timing tolerance	-10/+20 seconds per day
Lug to lug	48.55mm
Strap width	20mm



Setting the time and date

The crown should sit flush to the case (position **1**) in order to maintain water resistance.

- To re-power the watch after a period of non-use, simply wind the crown in a clockwise direction. Your C1 Moonglow has a maximum power reserve of 38 hours when fully wound. Normal wearing will allow the rotor to start re-powering the watch over time after putting on your wrist.
- To set the date pull out the crown gently into position **2**. Turn in a clockwise direction until the red shaded section on the date ring aligns with the correct date at the edge of the dial.
- To set the time pull out the crown gently into position **3**. This position is used for handsetting and stopping of the second hand. Turn the crown until you reach the correct time e.g. 10.08 hr. For precise time setting it is recommended to pass beyond the desired minute and to set the hand backwards.
- Setting the moon phase is relatively simple. For perfect synchronization, you will need the date of the last full or new moon. To adjust the moon phase pull gently into position **2**. Turn in an anti-clockwise direction to rotate the moonphase disk into the desired position. Rapid correction of the moonphase is possible at any time without risk of damaging the mechanism.

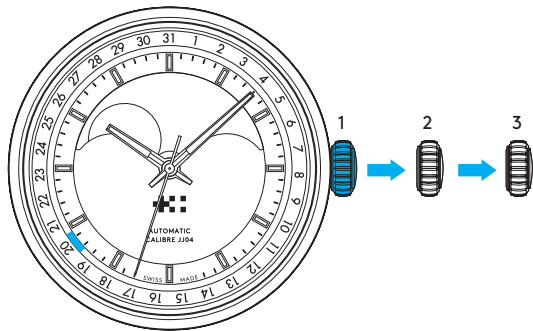

1. Manual winding

2. Date and moon phase setting

3. Time setting

PLEASE NOTE:

Date correction should not be carried out between 18.00 hr and 02.00 hr as the watch gearing will already be aligning itself to change the date. The crown should always be pushed in after adjustment, and it is best to do so from position 3 to avoid advancing beyond the desired date.

The moon and its phases

The phases of the moon cycle, from one new moon to the next one, lasts 29 days, 12 hours, 44 minutes and 2.8 seconds. The new moon corresponds to the first lunar day (fig. 1). The moon is not visible because its dark side is facing us. On the 8th day (fig. 2), after completing one quarter turn, a crescent moon appears on the left-hand side of the moonphase window with the curve facing to the right. On the 15th day of the lunar cycle (fig. 3), at the mid-point of its revolution, we see a fully illuminated circle at the 12 o'clock position, indicating the full moon. The moon at this point is directly opposite the sun. On the 23rd day of the lunar cycle (fig. 4),

at the end of its third quarter, the crescent appears on the right-hand side of the moonphase window.

A new lunar cycle now commences. The moon changes continuously between these characteristic positions. The time which has elapsed between two new moons corresponds to approximately one month. Due to the regular and repetitive nature of this movement and its phases, the moon has always served as a means of counting the passage of time. Indeed, this is why the lunar calendar is still used for timekeeping purposes.

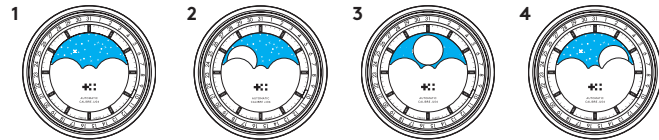

Straps and bracelets

As you would expect, we place as much emphasis on the quality of our straps and bracelets as we do our watches. We only use the finest materials in our straps, with quick-release pins also included for your convenience.

The following guidelines explain how easy it is to use, adjust and replace your Christopher Ward strap.

Using the quick-release pins on your strap

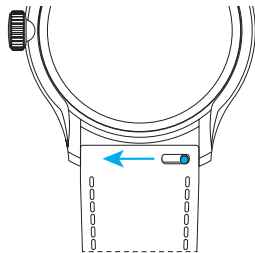

1. Locate the quick-release pin on your strap.
Pull the pin to the side to detach your strap.

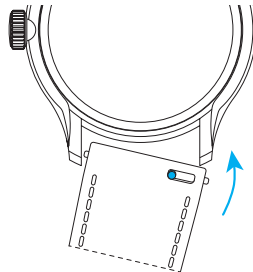

2. To reattach your strap, align the pins to the lug holes and click the strap into position. Repeat for the other side.

Water resistance

Although your watch has been through vigorous static pressure testing, it is worth remembering that there are many variables that can affect the water resistance of your watch. For instance, arm movements during swimming and the sudden impact of diving and water sports will drastically increase the pressure the watch is under.

Wearing your watch in the bath, shower, or sauna can also have an effect as a rapid increase in temperature can cause seals to expand and in extreme cases, malfunction or create condensation.

For these reasons, the water resistance rating of your watch (as shown) should only ever be considered a guideline and we strongly recommend they are always adhered to.



1 ATM (10 metres)

Safe to wear your watch while washing your hands with tap water



15 ATM (150 metres)

Safe to use while snorkelling in open water



100 ATM (1000 metres)

Professional deep sea diving



3 ATM (30 metres)

Washing your car and/or general hose pipe usage



30 ATM (300 metres)

Ideal for experienced divers and those practising scuba-diving



5 ATM (50 metres)

Water resistant to most household shower units



60 ATM (600 metres)

Professional divers, experiencing prolonged exposure underwater

60|60 Guarantee

Your watch is constructed from the finest components and powered by a Swiss mechanical movement. As with all quality watches, with the right care and attention, your new timepiece has the potential to become an heirloom, giving joy to future generations.

It's for this reason we've created an industry-leading approach to after-sales care, starting with our famous 60|60 Guarantee – the most comprehensive warranty in watchmaking.

60-day free returns

We hope you'll be happy with your watch from the moment it arrives. However, if that's not the case you have 60 days to return it in perfect, unused condition (with all its accompanying paperwork) in order to receive a replacement or full refund.

60-month movement guarantee

Your watch is powered by a precision-engineered Swiss movement. In the rare event that your movement develops a fault within five years we'll repair it for free under warranty. Your watch will need to be sent to us for a full diagnosis before processing a repair under warranty. We will always keep you informed before carrying out any work.

Service and repairs: the Christopher Ward way

Our approach to service and repairs is about uncompromised quality and great value for money. The process, led by our expert technicians, won't cost the earth and will have the watch back on your wrist in reasonable time. We recommend you service your watch every three to four years to keep it in peak condition.

PLEASE NOTE:

The 60|60 Guarantee does not cover accidental damage. Any service or repair by a third-party retailer will void your 60|60 Guarantee. For more details, please visit our website.

Contact us

Keeping in touch with Christopher Ward

From humble beginnings in 2004 (our first workshop was a refurbished chicken shed!) Christopher Ward has won a global following – and can justifiably claim to make the most affordable luxury watches in the world.

For many of our fans, the philosophy of trying to put luxury watches within the reach of everyone, is as smart as the timepieces themselves. This open approach sees co-founders Mike France and

Peter Ellis communicate personally with customers and listen to their feedback. Something that helps us improve our offering to you. As the owner of a Christopher Ward watch, if you ever need to get hold of us we're at your service. And if you'd like to explore the CW world more, you can follow us on social media.



@ChristopherWardLondon



@ChrisWardLondon

Head office

1 Park Street, Maidenhead,
Berkshire SL6 1SL
United Kingdom

Customer support

UK and EU Tel: +44 (0)1628 763040
US Tel: +1 (877) 380 2288
ROW Tel: +1 (877) 380 2288
customerservices@christopherward.co.uk
technical@christopherward.co.uk

christopherward.com

