

Time on your side...

Your Christopher Ward watch has been designed and engineered by highly talented craftspeople to ensure not only accurate and precise timekeeping but also to bring a real pride of ownership that only items of the highest quality can ever hope to deliver.

You have made an investment, a good one, and the aim of this handbook is to help you make the most of that investment during what I hope will be a lifetime of ownership.



Christopher Ward

Contents

C7 Rapide Automatic	2-3
Technical information	4-5
How to operate your C7 Rapide Automatic	6-10
Our watch care programme	11
Keeping in touch	12

C7 Rapide Automatic

From our award-winning twin flag logo at 12 o'clock, through to the bold new case and motorsport insignia-influenced dials, the Rapide Collection heralds a new era for motorsport at Christopher Ward. Similar to how petrolheads savour the meaty growl of a petrol engine, those of a horological disposition admire the intricacies of a mechanical movement; significantly, the C7 Rapide Automatic marks the introduction of a three-handed automatic model to our motorsport collection.

This is a watch with the charisma of motorsport at its very core: double sized numerals; a full minute track with inner triple minute marks for precise legibility; a 10 minute gauge highlighted like a rev meter. With a seamless blend of brushed and polished steel and titanium surfaces, our new four-piece case – designed exclusively for the Collection – is an engineering



masterclass, its powerful lugs reminiscent of the aerodynamic curves of a Formula 1 chassis.

Inside, a Sellita SW200-1 movement keeps the watch motoring away with unparalleled efficiency, its 28,800 vibrations per hour contributing to the smooth sweeping motion of the Automatic's coloured seconds hand.

Like many grand sports cars that have earned their place in motorsport history, the new C7 Rapide Automatic isn't one to usher itself in quietly. In fact, thanks to a bold new aesthetic partnered with an advanced case design, it introduces itself to the Collection with screeching tyres, billowing smoke and flying rubber as it donuts post-chequered flag!



Technical information

Features

- Swiss made
- 26 jewel self-winding mechanical movement
- 38 hour power reserve
- 316L stainless steel and aluminium four-piece case
- Aluminium bezel with 5 minute markers
- Screw-down crown
- Date window
- Anti-reflective flat sapphire crystal
- SuperLuminova® indexes
- Deep-stamped screw-down backplate with unique engraved serial number

Technical

Diameter:	42mm
Height:	11.15mm
Weight:	70g
Calibre:	Sellita SW 200-3
Case:	316L stainless steel and aluminium
Water Resistance:	10 ATM (100 metres)
Vibrations:	28,800 per hour (4Hz)
Timing tolerance:	±20 secs per day
Lug to lug:	48.2mm
Strap:	22mm



Setting the time/date

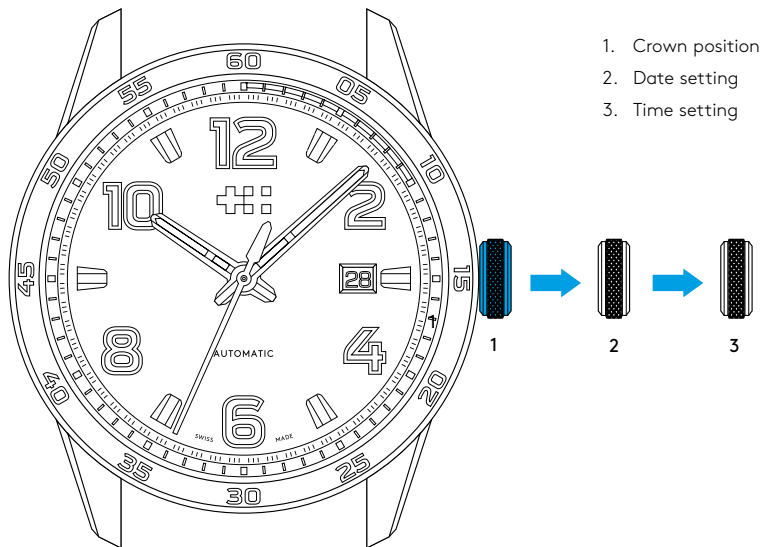

The crown should sit flush to the case (position 1) in order to maintain water resistance.

- For rapid date correction pull gently into position 2 and turn in a clockwise direction.
- For setting the time pull gently into position 3 and turn anti-clockwise to advance the time. For precise time setting it is recommended to pass beyond the desired minute and to set the hand backwards.
- Push the crown back to position 1.

PLEASE NOTE: Date correction should not be carried out between 20.00 hr and 02.00 hr as the watch gearing will already be aligning itself to change the date. The crown should always be pushed in after adjustment, and it is best to do so from position 3 to avoid advancing beyond the desired date.

Straps and bracelets

As you would expect, we place as much emphasis on the quality of our straps and bracelets as we do our watches. We only use the finest leathers for our straps. Similarly, we only use the finest metals in the construction of our bracelets, all of which are precision engineered for durability, efficiency and comfort.

The following guidelines explain how easy it is to use and adjust your Christopher Ward strap or bracelet.

Using the quick-release pins on your strap

1. Locate the quick-release pin on your strap. Pull the pin to the side to detach your strap.

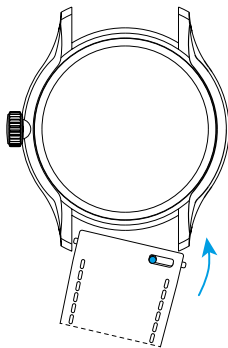
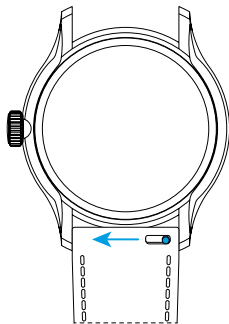

2. To reattach your strap, align the pins to the lug holes and click the strap into position. Repeat for the other side.

Integrated bracelet with micro adjustment

1. Press buttons to release.

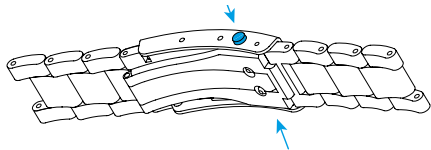

2. Pull open the clasp.

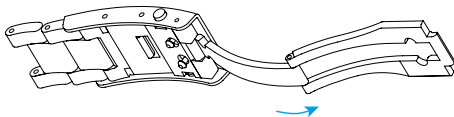

3. There are five micro adjustment positions, which allows for a maximum extension of 8.4mm. To extend, pull the lever to unlock and simultaneously pull on the bracelet into the desired position.

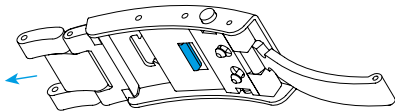

4. To shorten, simply push the bracelet back into the clasp.

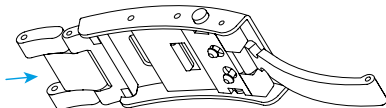

Water resistance

Although your watch has been through vigorous static pressure testing, it is worth remembering that there are many variables that can affect the water resistance of your watch.

For instance, arm movements during swimming and the sudden impact of diving and water sports will drastically increase the pressure the watch is under. Wearing your watch in the bath, shower, or sauna can also have an effect as a rapid increase in temperature can cause seals to expand and in extreme cases, malfunction or create condensation.

For these reasons, the water resistance rating of your watch (as shown) should only ever be considered a guideline and we strongly recommend they are always adhered to.



1 ATM (10 metres)

Safe to wear your watch while washing your hands with tap water.



3 ATM (30 metres)

Washing your car and/or general hose pipe usage.



10 ATM (100 metres)

Water resistant to most household shower units.



15 ATM (150 metres)

Safe to use while snorkelling in open water.



30 ATM (300 metres)

Ideal for experienced divers and those practising scuba-diving.



60 ATM (600 metres)

Professional divers, experiencing prolonged exposure underwater.



100 ATM (1000 metres)

Professional deep sea diving.

Our watch care programme

Your watch is constructed from the finest components and materials available including one of Switzerland's finest mechanical movements. As with all watches of this quality, with the right care and attention, your new Christopher Ward watch has the potential to become an heirloom piece giving further joy to future generations. It's for this reason we have created our industry leading approach to after-sales care, starting with our famous 60|60 Guarantee which remains the most comprehensive guarantee in the world of watchmaking.

Visit our website for more details about our 60|60 Guarantee and Service and Repair Programme.

60|60 Guarantee

1. 60 Day free returns

Our success depends on you being completely happy with your new Christopher Ward watch. You have up to 60 days to return your watch, absolutely free of charge, and receive a replacement or full refund by return – so long as it has not been worn and is returned in perfect condition.

2. 60 Month movement guarantee

Your watch, at its heart, has a top quality precision engineered Swiss movement – so it's very unlikely to give you problems with the minimum amount of care and attention, including a regular service. We recommend you return your watch to us every 3/4 years for a service, so our expert technicians can keep your fine timepiece in peak condition.

Servicing and repairs...the Christopher Ward way...

Our innovative approach to servicing and repairing your Christopher Ward watch means that having your watch serviced or repaired doesn't mean months of waiting followed by an exorbitant bill – which is more or less the experience guaranteed by every other luxury watch brand. We have developed an easy, quick and affordable expert service and repairs programme that doesn't cost the earth and has your watch back where it belongs – on your wrist – in double-quick time.

Keeping in touch with Christopher Ward

From small beginnings just a few short years ago (our first workshop was actually a refurbished chicken shed!), Christopher Ward has won a worldwide following for his eponymous watch brand and can justifiably claim to manufacture the most affordable luxury watches in the world.

For many, the philosophy behind the brand, of trying to put luxury watches within the reach of everyone, is as attractive as the watches themselves, as is the very open approach of the business which means that Chris and the team spend a lot of time communicating personally with our customers – many of whom have become friends.

As the owner of a Christopher Ward watch, if ever you need to get hold of us we are at your service. We have listed some useful contact details on the back cover.

There is also always something new going on at our website at **www.christopherward.co.uk** and, if you haven't already discovered the independent forum dedicated to our brand at **www.christopherwardforum.com** we would recommend a visit. Informative and fun, it's a great place to hear the unexpurgated view of Christopher Ward.