

C1 Bel Canto Limited Edition

Owner's Handbook



Time on your side

Your Christopher Ward watch has been designed in Britain and engineered in Switzerland by highly talented craftspeople. This ensures not only accurate and precise timekeeping, but also brings a real pride of ownership that only watches of the highest quality standards can hope to deliver.

You have made an investment, a good one, and the aim of this manual is to help you make the most of that investment in what we hope will be a lifetime of ownership.

Mike France
CEO & co-founder



C1 Bel Canto

Congratulations on the purchase of your C1 Bel Canto.

A watch made for those who appreciate the art of *haute horlogerie*.
A watch that delivers a feast for the ears – as well as the eyes.

At the core of your C1 Bel Canto is Calibre FS01, created by our technical director Frank Stelzer. With an inspired piece of lateral thinking, Frank realised that he could adapt CW's 'jumping hour' movement to create a chiming sound on the hour, every hour.

This chime comes courtesy of a steel spring placed around the edge of the dial. It's been tuned, so the sound is a delight for the ears (it's a 'D' note) while being loud enough to be heard from your wrist.

You'll also fall in love with the intricately stacked dial and the way the 41mm Light-catcher™ sits close to your wrist.

Finally, the most essential feature of all: you.

Because it's you that will develop a relationship with the C1 Bel Canto as time passes. It's you who'll wind the minute hand around the dial just to hear the chime.

And it's you who'll strap it onto your wrist every day and realise you're in the company of something extraordinary indeed.

Features

- Swiss made
- Limited Edition of 300 pieces
- 38-hour power reserve
- Self-winding 29-jewel movement with FS01 striking mechanism
- Floating time display
- Rhodium plated three-dimensional hand finished bridges and hammer mechanism
- On/off pusher at 4 o'clock
- Red on/off indicator
- Verde green sunray finished module plate
- Mirror polished chiming gong
- Brushed and polished Grade 5 Titanium Light-catcher™ case
- Deep-stamped screw-down caseback with sound wave motif
- Push-down crown with twin-flags motif
- Anti-reflective domed sapphire crystal
- Raised brushed and polished indexes filled with Super-LumiNova® C1 BL Grade X1
- Eco-friendly luxury presentation case and owner's handbook

Technical Information

Calibre	FS01
Case	Grade 5 titanium
Diameter	41mm
Height	13mm
Weight	53g
Water resistance	3 ATM (30 metres)
Vibrations	28,800 per hour (4Hz)
Timing tolerance	-20/+20 seconds per day
Lug to lug	48mm
Strap width	22mm



Setting the time

The crown should sit flush to the case (position **1**) in order to maintain water resistance.

- To re-power the watch after a period of non-use, simply wind the crown in a clockwise direction. Your C1 Bel Canto has a maximum power reserve of 38 hours when fully wound. Normal wearing will allow the rotor to start re-powering the watch over time after putting on your wrist.

- Pull gently into position **2**. This position is used for handsetting. For precise time setting it is recommended to pass beyond the desired minute and to set the hand backwards.

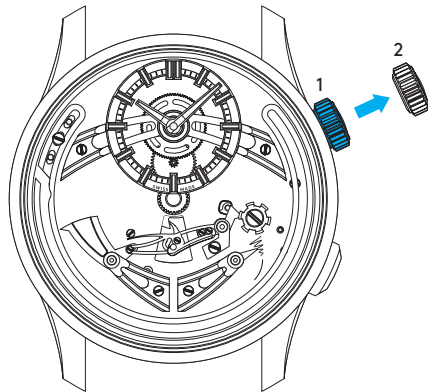

1. Manual winding

2. Time setting

Turning the chime on and off

Your C1 Bel Canto will chime on the hour, every hour.

If you'd like to turn this feature off, press the pusher at the 4 o'clock position on the case.

The red indicator on the dial will move from the chime position to the silent position.

When you want to hear the chime again, press the pusher once more and the indicator will move back to the original position.



Chime on



Chime off



Straps and bracelets

As you would expect, we place as much emphasis on the quality of our straps and bracelets as we do our watches. We only use the finest materials in our straps, with quick-release pins also included for your convenience.

The following guidelines explain how easy it is to use, adjust and replace your Christopher Ward strap or bracelet.

Using the quick-release pins on your strap/bracelet

1. Locate the quick-release pin (or pins) on your strap (A) or bracelet (B). Pull the pin(s) inwards to detach.
2. To reattach your strap (C) or bracelet (D), pull the pin(s) inwards, and align the spring bars so that they click securely into the lug holes on each side.

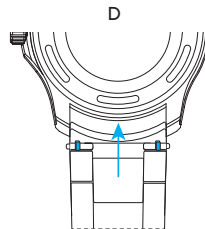
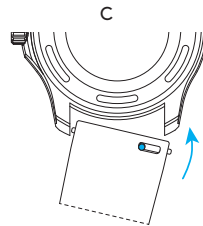
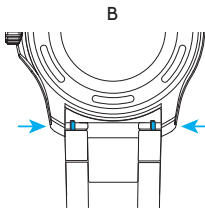
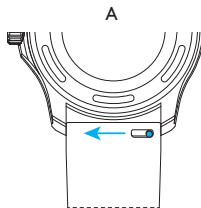

How to use the micro adjustment on your bracelet

1. Press buttons to release.
2. Pull open the clasp.
3. There are five micro adjustment positions, which allows for a maximum extension of 10mm. To extend, pull the lever to unlock and simultaneously pull on the bracelet into the desired position.
4. To shorten, simply pull the lever to unlock and push the bracelet back into the clasp.

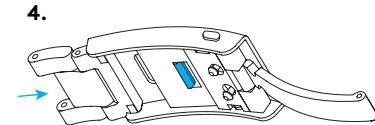
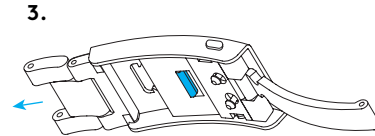
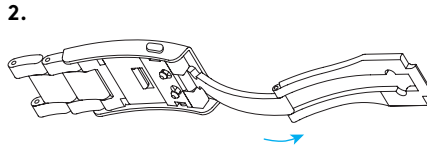
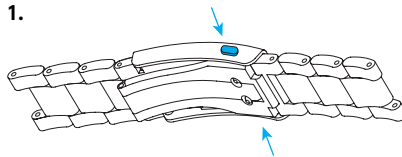

Water resistance

Although your watch has been through vigorous static pressure testing, it is worth remembering that there are many variables that can affect the water resistance of your watch. For instance, arm movements during swimming and the sudden impact of diving and water sports will drastically increase the pressure the watch is under.

Wearing your watch in the bath, shower, or sauna can also have an effect as a rapid increase in temperature can cause seals to expand and in extreme cases, malfunction or create condensation.

For these reasons, the water resistance rating of your watch (as shown) should only ever be considered a guideline and we strongly recommend they are always adhered to.



1 ATM (10 metres)

Safe to wear your watch while washing your hands with tap water



15 ATM (150 metres)

Safe to use while snorkelling in open water



100 ATM (1000 metres)

Professional deep sea diving



3 ATM (30 metres)

Washing your car and/or general hose pipe usage



30 ATM (300 metres)

Ideal for experienced divers and those practising scuba-diving



5 ATM (50 metres)

Water resistant to most household shower units



60 ATM (600 metres)

Professional divers, experiencing prolonged exposure underwater

60|60 Guarantee

Your watch is constructed from the finest components and powered by a Swiss mechanical movement. As with all quality watches, with the right care and attention, your new timepiece has the potential to become an heirloom, giving joy to future generations.

It's for this reason we've created an industry-leading approach to after-sales care, starting with our famous 60|60 Guarantee – the most comprehensive warranty in watchmaking.

60-day free returns

We hope you'll be happy with your watch from the moment it arrives. However, if that's not the case you have 60 days to return it in perfect, unused condition (with all its accompanying paperwork) in order to receive a replacement or full refund.

60-month movement guarantee

Your watch is powered by a precision-engineered Swiss movement. In the rare event that your movement develops a fault within five years we'll repair it for free under warranty. Your watch will need to be sent to us for a full diagnosis before processing a repair under warranty. We will always keep you informed before carrying out any work.

Service and repairs: the Christopher Ward way

Our approach to service and repairs is about uncompromised quality and great value for money. The process, led by our expert technicians, won't cost the earth and will have the watch back on your wrist in reasonable time. We recommend you service your watch every three to four years to keep it in peak condition.

PLEASE NOTE:

The 60|60 Guarantee does not cover accidental damage. Any service or repair by a third-party retailer will void your 60|60 Guarantee. For more details, please visit our website.

Contact us

Keeping in touch with Christopher Ward

From humble beginnings in 2004 (our first workshop was a refurbished chicken shed!) Christopher Ward has won a global following – and can justifiably claim to make the most affordable luxury watches in the world.

For many of our fans, the philosophy of trying to put luxury watches within the reach of everyone, is as smart as the timepieces themselves. This open approach sees co-founders Mike France and

Peter Ellis communicate personally with customers and listen to their feedback. Something that helps us improve our offering to you. As the owner of a Christopher Ward watch, if you ever need to get hold of us we're at your service. And if you'd like to explore the CW world more, you can follow us on social media.



@ChristopherWardLondon



@ChrisWardLondon

Head office

1 Park Street, Maidenhead,
Berkshire SL6 1SL
United Kingdom

Customer support

UK and EU Tel: +44 (0)1628 763040
US Tel: +1 (877) 380 2288
ROW Tel: +1 (877) 380 2288
customerservices@christopherward.co.uk
technical@christopherward.co.uk

christopherward.com

