

C8 Power Reserve  
Chronometer

Owner's handbook

Christopher  
Ward

## Time on your side...

Your Christopher Ward watch has been designed and engineered by experts to ensure not only precise timekeeping, but also to give you a sense of pride whenever you wear it.

You've made an investment, a good one, and the aim of this handbook is to help you make the most of it during what I hope will be a lifetime of ownership.



Christopher Ward

### Contents

C8 Power Reserve Chronometer	2-3
Technical information	4-5
How to operate your C8 Power Reserve	6-10
Our watch care programme	11
Keeping in touch	12

## C8 Power Reserve

When our Calibre SH21 movement was launched in 2014, its designer, Johannes Jahnke, promised that it would provide a canvas for him to experiment with further innovations and complications. The new C8 Power Reserve Chronometer shows this has now become a reality.



With its DLC (diamond-like carbon) black case and dial, highly legible indexes and Arabic numerals, the C8 PR COSC carries with it many of the design cues of famous aviation timepieces like the Smith's Mark II A clock found in the Spitfire. In truth, it feels more like a timing instrument than regular watch.

The hand-wound version of our own movement is every bit as impressive as its automatic sibling. Thanks to its twin barrels, when fully wound, it'll deliver an incredible five days of power.

Like the self-winding version of Calibre SH21, chronometer status is standard, while a power reserve complication – as promised in the name of the watch – counts down the time until the next wind.



## Technical information

### Features

- In-house calibre SH21 hand-wound movement (100% Swiss made) with power reserve complication
- 120 hour power reserve
- Decorated twin barrels of SH21 visible through exhibition caseback
- Bridge engraved and finished in black PVD
- Marine-grade black DLC steel case
- Date wheel with numbers cut from disc
- Power reserve indicator
- Seconds sub dial
- Push-down crown with stamped design
- Gun-metal hands
- Light Old Radium SuperLuminova® on hands and indices

- 'Whip stitch vintage leather strap
- Beautiful presentation case and owner's handbook

### Technical information

<b>Diameter:</b>	44mm
<b>Height:</b>	11mm
<b>Weight:</b>	81g
<b>Calibre:</b>	SH21 hand-wound automatic
<b>Case:</b>	316L stainless steel
<b>Water Resistance:</b>	5 ATM (50 metres)
<b>Vibrations:</b>	28,800 per hour (4 Hz)
<b>Timing tolerance:</b>	-4/+6 seconds per day
<b>Lug to lug:</b>	53.2mm
<b>Strap:</b>	22mm



## Setting the time/date

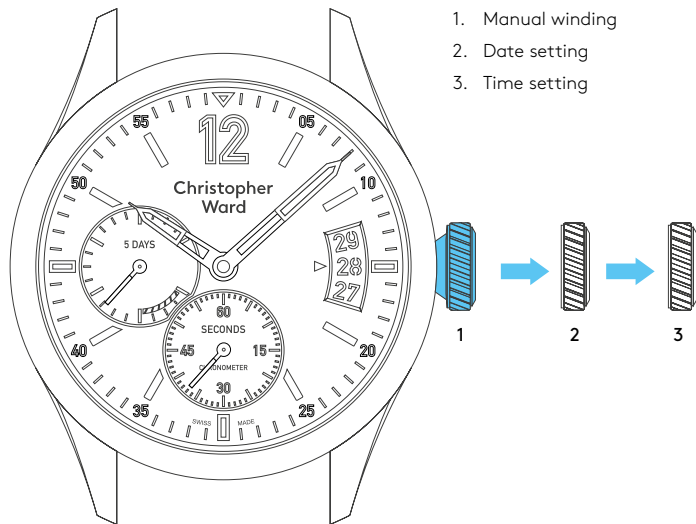

1. Manual winding
2. Date setting
3. Time setting

The crown should sit flush to the case (position 1) in order to maintain water resistance.

- To re-power the watch after a period of non-use, simply wind the crown in a clockwise direction until the power reserve indicator shows 100% power.
- Pull gently into position 2. For rapid date correction, turn in an anti-clockwise direction.
- To set the time pull out the crown gently into position 3. This position is used for handsetting and stopping of the second hand. Turn the crown until you reach the correct time e.g. 10.08 hr. For precise time setting it is recommended you pass beyond the desired minute and to set the hand backwards.

**PLEASE NOTE:** As this watch uses a manually wound mechanical movement, take care not to overwind the crown past the point of resistance as it will damage the movement.

Date correction should not be carried out between 20.00 hr and 02.00 hr as the watch gearing will already be aligning itself to change the date.



## The power reserve function

The power reserve indicator shows the winding status of the main spring.

- When the hand is in position **A**, the movement is close to stopping. The watch should therefore be wound manually to obtain a maximum power reserve.
- When the hand is in position **B**, the watch is at its maximum winding position. Take care not to overwind the crown past the point of resistance as it will damage the movement.

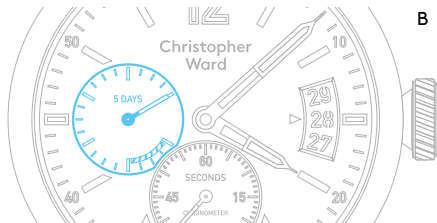
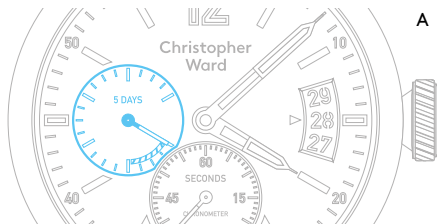



## Water resistance

Although your watch has been through vigorous static pressure testing, it is worth remembering that there are many variables that can affect the water resistance of your watch.

For instance, arm movements during swimming and the sudden impact of diving and water sports will drastically increase the pressure the watch is under. Wearing your watch in the bath, shower, or sauna can also have an effect as a rapid increase in temperature can cause seals to expand and in extreme cases, malfunction or create condensation.

For these reasons, the water resistance rating of your watch (as shown) should only ever be considered a guideline and we strongly recommend they are always adhered to.



### **1 ATM (10 metres)**

Safe to wear your watch while washing your hands with tap water.



### **3 ATM (30 metres)**

Washing your car and/or general hose pipe usage.



### **5 ATM (50 metres)**

Water resistant to most household shower units.



### **15 ATM (150 metres)**

Safe to use while snorkelling in open water.



### **30 ATM (300 metres)**

Ideal for experienced divers and those practising scuba-diving.



### **50 ATM (500 metres)**

Professional divers, experiencing prolonged exposure underwater.



### **100 ATM (1000 metres)**

Professional deep sea diving.

## Our watch care programme

Your watch is constructed from the finest components and materials available including one of Switzerland's finest mechanical movements. As with all watches of this quality, with the right care and attention, your new Christopher Ward watch has the potential to become an heirloom piece giving further joy to future generations. It's for this reason we have created our industry leading approach to after-sales care, starting with our famous 60|60 Guarantee which remains the most comprehensive guarantee in the world of watchmaking.

Visit our website for more details about our 60|60 Guarantee and Service and Repair Programme.

### **60|60 Guarantee**

#### **1. 60 Day free returns**

Our success depends on you being completely happy with your new Christopher Ward watch. You have up to 60 days to return your watch, absolutely free of charge, and receive a replacement or full refund by return – so long as it has not been worn and is returned in box-perfect condition.

#### **2. 60 Month movement guarantee**

Your watch, at its heart, has a top quality precision engineered Swiss movement – so it's very unlikely to give you problems with the minimum amount of care and attention, including a regular service. We recommend you return your watch to us every 3/4 years for a service, so our expert technicians can keep your fine timepiece in peak condition.

### **Servicing and repairs...the Christopher Ward way...**

Our innovative approach to servicing and repairing your Christopher Ward watch means that having your watch serviced or repaired doesn't mean months of waiting followed by an exorbitant bill – which is more or less the experience guaranteed by every other luxury watch brand. We have developed an easy, quick and affordable expert service and repairs programme that doesn't cost the earth and has your watch back where it belongs – on your wrist – in double-quick time.

## Keeping in touch with Christopher Ward

From small beginnings just a few short years ago (our first workshop was actually a refurbished chicken shed!), Christopher Ward has won a worldwide following for his eponymous watch brand and can justifiably claim to manufacture the most affordable luxury watches in the world.

For many, the philosophy behind the brand, of trying to put luxury watches within the reach of everyone, is as attractive as the watches themselves, as is the very open approach of the business which means that Chris and the team spend a lot of time communicating personally with our customers – many of whom have become friends.

As the owner of a Christopher Ward watch, if ever you need to get hold of us we are at your service. We have listed some useful contact details on the back cover.

There is also always something new going on at our website at **[www.christopherward.co.uk](http://www.christopherward.co.uk)** and, if you haven't already discovered the independent forum dedicated to our brand at **[www.christopherwardforum.com](http://www.christopherwardforum.com)** we would recommend a visit. Informative and fun, it's a great place to hear the unexpurgated view of Christopher Ward.



**Head Office**

1 Park Street, Maidenhead,  
Berkshire SL6 1SL  
United Kingdom

**Customer Services**

UK: +44 (0)1628 763040  
USA: +44 (0)1.877.226.8224  
[customerservices@christopherward.co.uk](mailto:customerservices@christopherward.co.uk)  
[technical@christopherward.co.uk](mailto:technical@christopherward.co.uk)

[christopherward.co.uk](http://christopherward.co.uk)