

C1 Moonphase

Owner's Handbook

 Christopher
Ward

Time on your side

Your Christopher Ward watch has been designed in England and built by hand in Switzerland by highly talented craftspeople. This ensures not only accurate and precise timekeeping, but also brings a real pride of ownership that only watches of the highest quality standards can hope to deliver.

You have made an investment, a good one, and the aim of this manual is to help you make the most of that investment in what we hope will be a lifetime of ownership.

Mike France
CEO & co-founder



C1 Moonphase

Congratulations on purchasing your C1 Moonphase: without doubt one of the most beautiful moonphase watches on the market.

The unadorned dial is made from aventurine – a glass invented on the Venetian island of Murano – infused with reflective flakes of copper oxide that resemble the night sky. The revolving disc behind is also constructed in aventurine.

Dominating the dial is the moon (or moons: two are in constant rotation), made from Globolight, a ceramic-Super-LumiNova mix that allows for intricate sculpting. The moon is covered with a four-colour print of the moon's surface, which brings a new level of realism to the moonphase genre.

The power behind the glory is Calibre JJ04, our in-house modular movement, which will allow the watch's 'moon' to follow the actual moon's journey around the sky accurately for 128 years.

This beautiful watch deserves to be seen, so our advice is to strap it on and take it out into the world. And if it's a clear night with the moon shining bright, so much the better.



Display and control

C1 Moonphase has a maximum power reserve of 38 hours when fully wound. To re-power the watch after a period of non-use, simply wind the crown in a clockwise direction for approximately 20 revolutions. Normal wearing will very quickly allow the rotor to start re-powering the watch over time after putting it on your wrist.

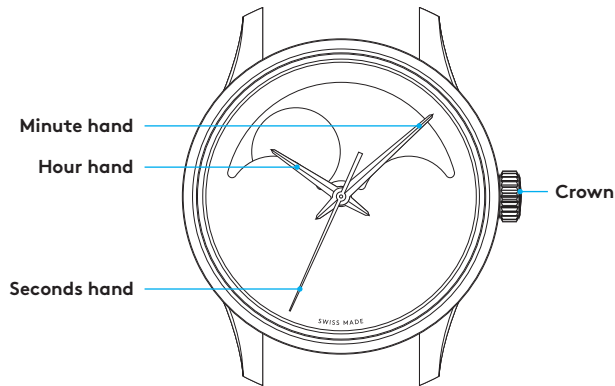

Features

- Swiss made
- Self-winding 26 jewel movement with 'JJ04' in-house Moonphase module
- 38-hour power reserve
- Brushed and polished marine-grade stainless steel Light-catcher™ case
- Diamond-like carbon (DLC) finished rotor with twin-flags engraving
- Exhibition backplate with unique engraved serial number
- Push-down crown with twin-flags motif
- Three dimensional luminescent Globolight moons
- Anti-reflective box sapphire crystal
- Aventurine dial and moon disc
- Super-LumiNova® Grade X1 WL C1 moons
- Fully polished hands
- Eco-friendly luxury presentation case and owner's handbook

Technical Information

Calibre	Sellita SW220 with 'JJ04' module
Case	Stainless steel
Diameter	40.5mm
Height	13.3mm
Weight	67g
Water resistance	3 ATM (30 metres)
Vibrations	28,800 per hour (4Hz)
Timing tolerance	-20/+20 seconds per day
Lug to lug	47.9mm
Strap width	20mm



Setting the time and moon phase

The crown should sit flush to the case (position **1**) in order to maintain water resistance.

- To re-power the watch after a period of non-use, simply wind the crown in a clockwise direction. Your C1 Moonphase has a maximum power reserve of 38 hours when fully wound.
- Setting the moon phase is relatively simple. For perfect synchronization, you will need the date of the last full or new moon. To adjust the moon phase pull gently into position **2**.

Turn in an anti-clockwise direction to rotate the moonphase disk into the desired position. Rapid correction of the moonphase is possible at any time without risk of damaging the mechanism.

- To set the time pull out the crown gently into position **3**. This position is used for handsetting and stopping of the second hand. Turn the crown until you reach the correct time e.g. 10.08 hr. For precise time setting it is recommended to pass beyond the desired minute and to set the hand backwards.

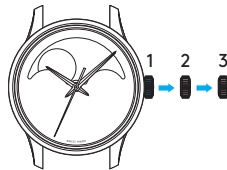

- 1.** Manual winding
- 2.** Moon phase setting
- 3.** Time setting

The moon and its phases

The phases of the moon cycle, from one new moon to the next one, lasts 29 days, 12 hours, 44 minutes and 2.8 seconds. The new moon corresponds to the first lunar day (fig. **1**). The moon is not visible because its dark side is facing us. On the 8th day (fig. **2**), after completing one quarter turn, a crescent moon appears on the left-hand side of the moonphase window with the curve facing to the right. On the 15th day of the lunar cycle (fig. **3**), at the mid-point of its revolution, we see a fully illuminated circle at the 12 o'clock position, indicating the full moon. The moon at this point is directly opposite the sun. On the 23rd day of the lunar cycle (fig. **4**),

at the end of its third quarter, the crescent appears on the right-hand side of the moonphase window.

A new lunar cycle now commences. The moon changes continuously between these characteristic positions. The time which has elapsed between two new moons corresponds to approximately one month. Due to the regular and repetitive nature of this movement and its phases, the moon has always served as a means of counting the passage of time. Indeed, this is why the lunar calendar is still used for timekeeping purposes.

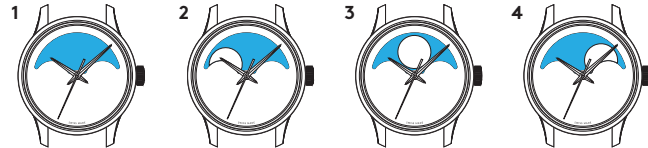

Straps and bracelets

As you would expect, we place as much emphasis on the quality of our straps and bracelets as we do our watches. We only use the finest materials in our straps, with quick-release pins also included for your convenience.

The following guidelines explain how easy it is to use, adjust and replace your Christopher Ward strap or bracelet.

Using the quick-release pins on your strap/bracelet

1. Locate the quick-release pin (or pins) on your strap (A) or bracelet (B). Pull the pin(s) inwards to detach.
2. To reattach your strap (C) or bracelet (D), pull the pin(s) inwards, and align the spring bars so that they click securely into the lug holes on each side.

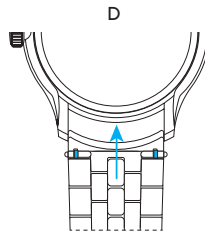
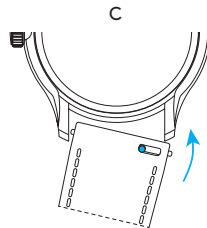
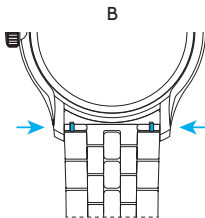
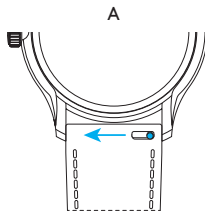

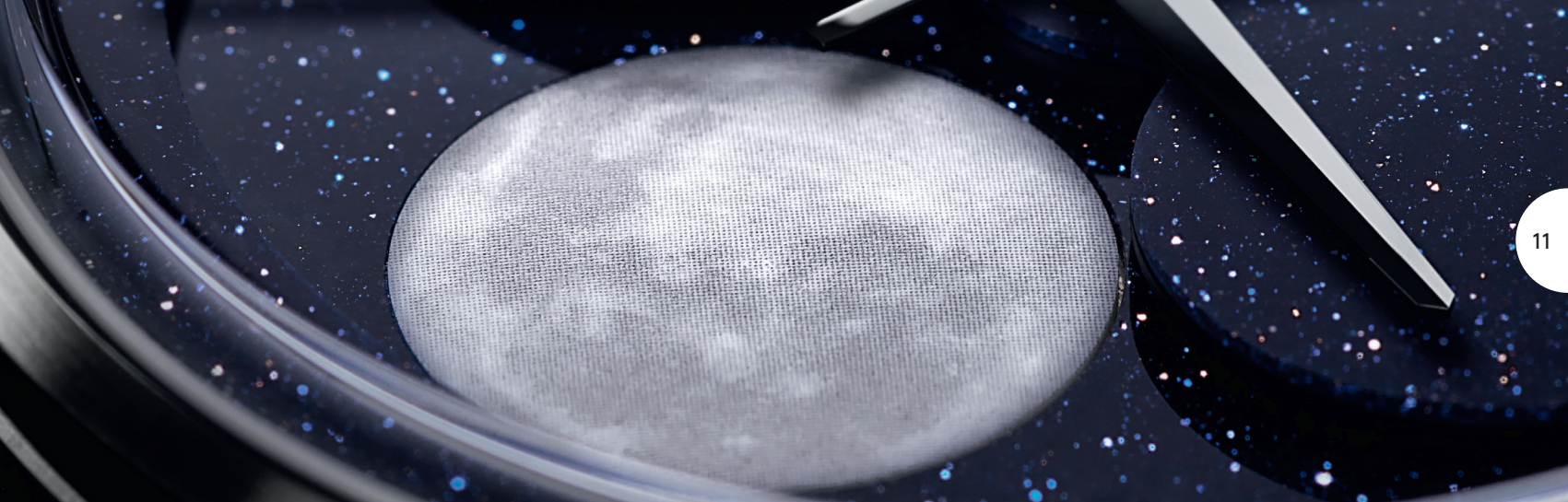

Water resistance

Although your watch has been through vigorous static pressure testing, it is worth remembering that there are many variables that can affect the water resistance of your watch. For instance, arm movements during swimming and the sudden impact of diving and water sports will drastically increase the pressure the watch is under.

Wearing your watch in the bath, shower, or sauna can also have an effect as a rapid increase in temperature can cause seals to expand and in extreme cases, malfunction or create condensation.

For these reasons, the water resistance rating of your watch (as shown) should only ever be considered a guideline and we strongly recommend they are always adhered to.



1 ATM (10 metres)

Safe to wear your watch while washing your hands with tap water



15 ATM (150 metres)

Safe to use while snorkelling in open water



100 ATM (1000 metres)

Professional deep sea diving



3 ATM (30 metres)

Washing your car and/or general hose pipe usage



30 ATM (300 metres)

Ideal for experienced divers and those practising scuba-diving



5 ATM (50 metres)

Water resistant to most household shower units



60 ATM (600 metres)

Professional divers, experiencing prolonged exposure underwater

60|60 Guarantee

Your watch is constructed from the finest components and powered by a Swiss mechanical movement. As with all quality watches, with the right care and attention, your new timepiece has the potential to become an heirloom, giving joy to future generations.

It's for this reason we've created an industry-leading approach to after-sales care, starting with our famous 60|60 Guarantee – the most comprehensive warranty in watchmaking.

60-day free returns

We hope you'll be happy with your watch from the moment it arrives. However, if that's not the case you have 60 days to return it in perfect, unused condition (with all its accompanying paperwork) in order to receive a replacement or full refund.

60-month movement guarantee

Your watch is powered by a precision-engineered Swiss movement. In the rare event that your movement develops a fault within five years we'll repair it for free under warranty. Your watch will need to be sent to us for a full diagnosis before processing a repair under warranty. We will always keep you informed before carrying out any work.

Service and repairs: the Christopher Ward way

Our approach to service and repairs is about uncompromised quality and great value for money. The process, led by our expert technicians, won't cost the earth and will have the watch back on your wrist in reasonable time. We recommend you service your watch every three to four years to keep it in peak condition.

PLEASE NOTE:

The 60|60 Guarantee does not cover accidental damage. Any service or repair by a third-party retailer will void your 60|60 Guarantee. For more details, please visit our website.

Contact us

Keeping in touch with Christopher Ward

From humble beginnings in 2004 (our first workshop was a refurbished chicken shed!) Christopher Ward has won a global following – and can justifiably claim to make the most affordable luxury watches in the world.

For many of our fans, the philosophy of trying to put luxury watches within the reach of everyone, is as smart as the timepieces themselves. This open approach sees co-founders Mike France and

Peter Ellis communicate personally with customers and listen to their feedback. Something that helps us improve our offering to you. As the owner of a Christopher Ward watch, if you ever need to get hold of us we're at your service. And if you'd like to explore the CW world more, you can follow us on social media.



@ChristopherWardLondon



@ChrisWardLondon

Head office

1 Park Street, Maidenhead,
Berkshire SL6 1SL
United Kingdom

Customer support

UK and EU Tel: +44 (0)1628 763040
US Tel: +1 (877) 380 2288
ROW Tel: +1 (877) 380 2288
customerservices@christopherward.co.uk
technical@christopherward.co.uk

christopherward.com

