

C65 GMT Worldtimer

Owner's Handbook

 Christopher
Ward

Time on your side

Your Christopher Ward watch has been designed in Britain and engineered in Switzerland by highly talented craftspeople. This ensures not only accurate and precise timekeeping, but also brings a real pride of ownership that only watches of the highest quality standards can hope to deliver.

You have made an investment, a good one, and the aim of this manual is to help you make the most of that investment in what we hope will be a lifetime of ownership.

Mike France
CEO & Co-founder



C65 GMT Worldtimer

In an age where we can connect with friends and family around the world in seconds, the C65 GMT Worldtimer serves as a mechanical reminder of the many sublime places that exist upon our planet.

Now, imagine back to the 1960s: a time where commercial supersonic flights had just arrived, destinations that had once been but a pipe dream for many were now within reach and Pan Am pilots were revered like rockstars. It's this spirit of liberation that's captured in the C65 GMT Worldtimer.

Inheriting the '60s dive watch cues atypical of our C65 family, this new addition then debuts worldtimer functionality, plus a GMT hand powered by a Swiss-made Sellita SW330 movement. Significant for being the first

time both have been present together in any CW release, the two combine to offer multiple solutions for tracking various timezones abroad.

And while its enlarged worldtimer bezel might tell you exactly what the current time is in Dhaka, the C65's protruding 'glass box' crystal, baton-shaped hands and tool watch aesthetic may just convince you that you're in the mid-1960s!



Display and control buttons

Your C65 GMT Worldtimer has a maximum power reserve of 42 hours when fully wound. To re-power the watch after a period of non-use, simply wind the crown in a clockwise direction for approximately 20 revolutions. Normal wearing will very quickly allow the rotor to start re-powering the watch over time after putting it on your wrist.

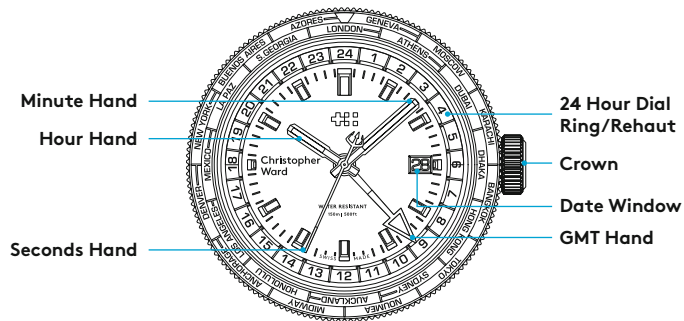

Features

- Swiss made
- 25 jewel self-winding mechanical movement
- 42 hour power reserve
- Dual-time GMT function
- Date calendar
- Central hacking seconds
- Anti-shock system
- Christopher Ward 'Colimaçone' finish on rotor
- Brushed and polished marine-grade stainless steel case
- Bi-directional steel bezel with printed international cities and brushed steel/black diamond-like carbon (DLC) finishing
- "Glass box" sapphire crystal
- Screw-down crown stamped with twin-flag motif
- Matte finish dial with twin flags debossed at 12 o'clock
- Yellow and white flat 24 hour dial ring/rehaut with printed numerals
- Super-LumiNova® Grade X1 GL C1-filled hands and indexes
- Top-brushed indexes with diamond polished facets
- Signature Trident counter-balance on seconds hand
- Black diamond-like carbon (DLC) "Trident" motif screw-down backplate
- Unique engraved serial number

Technical Information

| | |
|------------------|--------------------------------|
| Calibre | Sellita SW330 |
| Case | 316L stainless steel |
| Diameter | 41mm (42mm on bezel) |
| Height | 12.05mm |
| Weight | 71g |
| Water resistance | 15 ATM (150 metres) |
| Vibrations | 28,800 per hour (4 Hz) |
| Timing tolerance | -20/+20 seconds per day |
| Lug to lug | 47.1mm |
| Strap width | 22mm |



Setting the time and date

The crown should sit flush to the case (position **1**) in order to maintain water resistance.

- To re-power the watch after a period of non-use, simply wind the crown in a clockwise direction. Your C65 GMT Worldtimer has a maximum power reserve of 42 hours when fully wound.
- Pull gently into position **2**. For rapid date correction, turn in an anti-clockwise direction. To set the GMT hand, turn the crown clockwise and rotate the hand until you have reached the desired time indication. The GMT hand moves in one-hour increments.
- To set the time pull out the crown gently into position **3**. This position is used for handsetting and stopping of the seconds hand. Turn the crown until you reach the correct time e.g. 10.08 hr. For precise time setting it is recommended you pass beyond the desired minute and to set the hand backwards.

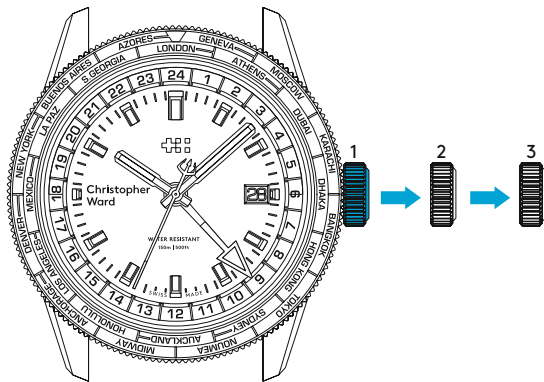

1. Manual winding
2. Date/GMT setting
3. Time setting

PLEASE NOTE:

Date correction should not be carried out between 20.00 hr and 02.00 hr as the watch gearing will already be aligning itself to change the date. The crown should always be pushed in after adjustment, and it is best to do so from position 3 to avoid advancing beyond the desired date.

Using the GMT hand for travel

Set the time in your new destination by pulling the crown into position **3** and move the hour/minute hands until they indicate the desired time.

Push crown into position **2** and wind, clockwise, the GMT hand around the 24-hour scale on the 24 hour dial ring/rehaut until you have the right time at home. E.g. If you're travelling from London at 12:10 to New York, you would turn the hour/minute hands to 7:10 (New York time is five hours behind London) and wind the GMT hand around to the 12:10 position.

Once set, it means that, for example, you can gauge the time to ring your friends and family without waking them in the middle of the night.

How to operate your C65 GMT Worldtimer

How to use the GMT hand if you're staying at home

If you have relatives or work colleagues in another timezone, you can use the GMT hand to mark what time it is in their country. Just gently pull the crown into position **2**, then use the 24-hour dial ring/rehaut (note the contrasting 'day', and 'night' sections) to set the time there. E.g. If the GMT in London is 12:05, in Australia it would be 22:05 (+10 hours).

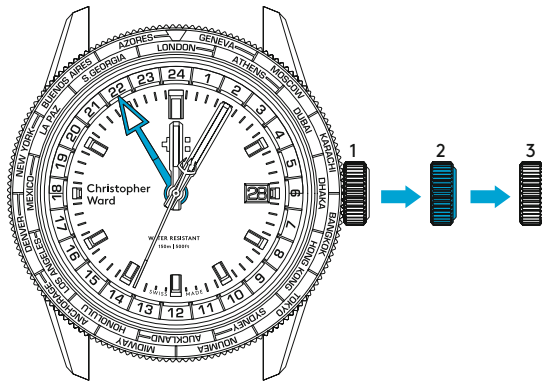

Using the Worldtimer bezel

- The rotating bezel with international cities has no relationship to the GMT hand. Instead it's a tool to gauge the time instantly in another part of the world. By rotating the bezel of your watch to the current GMT time, you can see the time in the other time zones separated by a full hour.
- To set the bezel to a specific city location, rotate the bezel clockwise or anti-clockwise until your home time zone reaches the current time on the 24 hour dial ring/rehaut (e.g. if you're in the UK and it's 2pm, move 'London' to 14.00). From there you can work out the time in any part of the world (eg: at 14.00 in the UK, it's 22.00 in Hong Kong).





Straps and bracelets

As you would expect, we place as much emphasis on the quality of our straps and bracelets as we do our watches. We only use the finest materials in our straps, with quick-release pins also included for your convenience.

The following guidelines explain how easy it is to use, adjust and replace your Christopher Ward strap or bracelet.

Using the quick-release pins on your strap/bracelet

1. Locate the quick-release pin (or pins) on your strap (A) or bracelet (B). Pull the pin(s) inwards to detach.
2. To reattach your strap (C) or bracelet (D), pull the pin(s) inwards, and align the spring bars so that they click securely into the lug holes on each side.

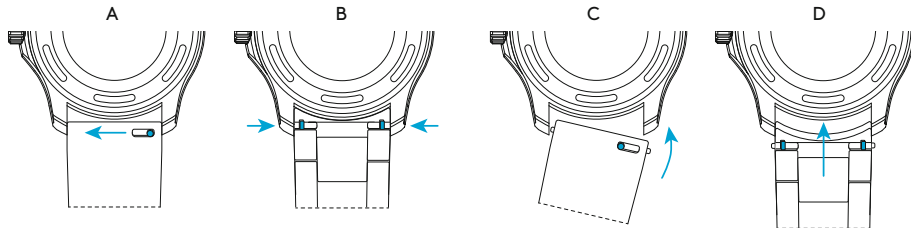

How to use the micro adjustment on your bracelet

1. Press buttons to release.
2. Pull open the clasp.
3. There are five micro adjustment positions, which allows for a maximum extension of 8.4mm. To extend, pull the lever to unlock and simultaneously pull on the bracelet into the desired position.
4. To shorten, simply push the bracelet back into the clasp.

1.

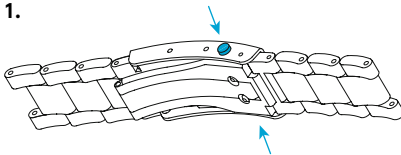

2.

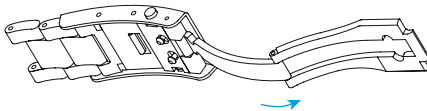

3.

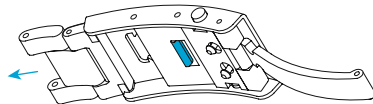

4.

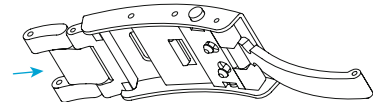

Water resistance

Although your watch has been through vigorous static pressure testing, it is worth remembering that there are many variables that can affect the water resistance of your watch. For instance, arm movements during swimming and the sudden impact of diving and water sports will drastically increase the pressure the watch is under.

Wearing your watch in the bath, shower, or sauna can also have an effect as a rapid increase in temperature can cause seals to expand and in extreme cases, malfunction or create condensation.

For these reasons, the water resistance rating of your watch (as shown) should only ever be considered a guideline and we strongly recommend they are always adhered to.



1 ATM (10 metres)

Safe to wear your watch while washing your hands with tap water



15 ATM (150 metres)

Safe to use while snorkelling in open water



100 ATM (1000 metres)

Professional deep sea diving



3 ATM (30 metres)

Washing your car and/or general hose pipe usage



30 ATM (300 metres)

Ideal for experienced divers and those practising scuba-diving



5 ATM (50 metres)

Water resistant to most household shower units



60 ATM (600 metres)

Professional divers, experiencing prolonged exposure underwater

Our watch care programme

60|60 Guarantee

Your watch is constructed from the finest components and materials available including one of Switzerland's finest mechanical movements. As with all watches of this quality, with the right care and attention, your new Christopher Ward watch has the potential to become an heirloom piece giving further joy to future generations.

It's for this reason we have created our industry leading approach to after-sales care, starting with our famous 60|60 Guarantee which remains the most comprehensive guarantee in the world of watchmaking.

60 Day Free Returns

Our success depends on you being completely happy with your new Christopher Ward watch. You have up to 60 days from despatch to return your watch, with free shipping, and receive a replacement or full refund, for which the watch must be in perfect, unworn condition and accompanied by all its original packaging and paperwork.

60 Month Movement Guarantee

Your watch has a top-quality precision engineered Swiss movement – but if it develops a movement fault within 5 years, and has been serviced by us at the recommended interval (within a maximum of 4 years from date of despatch), we will repair it for free under warranty. Not all mechanical problems or quartz battery replacements are

considered movement faults and your watch will need to be sent to us for diagnosis and service history checks, before processing a repair under warranty.

Servicing and Repairs - the Christopher Ward way...

Our innovative approach to service and repair means that having your watch attended to doesn't mean months of waiting followed by an exorbitant bill. We have developed a quick, easy and affordable expert service and repairs process that doesn't cost the earth and has the watch back where it belongs – on your wrist – in reasonable time.

We recommend you service your watch at intervals of 3-4 years to keep it in peak condition and to maintain your **60 month guarantee**. If your watch develops an issue within 60 months of despatch, we will first check its service history before progressing a repair. If you have not had your watch serviced at the recommended interval, we will not cover the cost of the repair under warranty, and will recommend a maintenance service in addition to any repair work due.

christopherward.co.uk/cservices/60-60-guarantee

Contact us

Keeping in touch with Christopher Ward

From small beginnings just 15 years ago (our first workshop was actually a refurbished chicken shed!), Christopher Ward has won a worldwide following and can justifiably claim to manufacture the most affordable luxury watches in the world. For many, the philosophy behind the brand, of trying to put luxury watches within the reach of everyone, is as smart as the watches themselves. The very open approach of the business sees Chris, Mike and Peter, as well as the rest of the team, spending lots of time communicating

personally with customers – listening to feedback which helps us continually improve as we grow. As the owner of a Christopher Ward watch, if you ever need to get hold of us we are at your service. There is always something new on our website, across our social media communities and on the Christopher Ward Forum – informative and fun, these are the best places to join the conversation about the latest new releases, news and offers in the world of Christopher Ward.

Head Office

1 Park Street, Maidenhead,
Berkshire SL6 1SL
United Kingdom

Customer Services

UK: +44 (0)1628 763040
USA: 1.877.226.8224
customerservices@christopherward.co.uk
technical@christopherward.co.uk

christopherward.co.uk

