

# C2 Lido

O W N E R ' S      H A N D B O O K

## Time on your side...

Your Christopher Ward watch has been designed and engineered by highly talented craftspeople to ensure not only accurate and precise timekeeping but also to bring a real pride of ownership that only luxury items of the highest quality can ever hope to deliver.

You have made an investment, a good one, and the aim of this handbook is to help you make the most of that investment during what I hope will be a lifetime of ownership.

A handwritten signature in black ink that reads "Chris". The letters are fluid and cursive, with a prominent initial "C" and a small dot above the "i".

Christopher Ward



# Caring for your Christopher Ward quartz watch

Your C2 Lido is constructed from the finest components and materials available including one of Switzerland's finest quartz movements.

As with all watches of this quality, with just a little care, it has the potential to become an heirloom piece giving further joy to future generations.

Here are a few hints to help keep your watch working perfectly over the years:

- Although the battery in your watch may last longer, we recommend you have it changed every 2/3 years by a reputable watch repairer.
- At the same time as having the battery changed it makes sense to have the watch repairer clean and lubricate your watch as necessary.
- Make sure the crown is screwed down fully before putting the watch into water. Adhere to the water resistance ratings towards the end of the handbook to prevent water getting to the movement which could result in a very costly repair or the need for a replacement movement.
- Your watch is shock resistant to minor impacts but dropping from height onto a hard surface may damage the movement.

Should you need a replacement part - don't worry, we keep stocks of spare parts for years, even for discontinued models. It's all part of the Christopher Ward service.

Finally, don't forget our famous **60:60 Guarantee** allows you to return your watch absolutely free, for any reason, and with no quibbles, for up to 60 days after purchase and we also guarantee your movement for up to 60 months.

After all, why shouldn't you enjoy peace of mind as much as you enjoy your watch?



# The C2 Lido

## Features

7 jewel Swiss quartz movement

Convex sapphire crystal with anti-reflective coating

Water resistant to 10 atm

Adjustable quick-release butterfly clasp

Screwdown case with unique serial number

Day/date window

Retro-styled guilloché dial

Screw-in crown

End-of-life battery indicator

## Technical Data

Diameter: 40mm

Height: 8.5mm

Weight: 80g - 140g

Case: 316L Stainless steel

Calibre: ETA 955.122

Accuracy: +20 / -10 seconds per month

# Description of the display and control buttons

## Display elements

Minute Hand

Hour hand

Second hand

Day/Date Window

## Control buttons

Crown

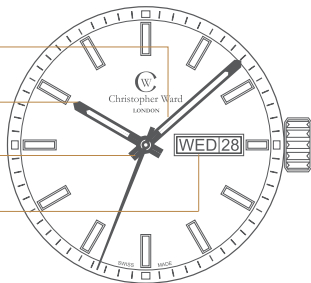



## Setting the time and date

To get to position ①, turn the crown anti-clockwise until it releases itself.

- From position ①, pull the crown to position ② and adjust the calendar display in a clockwise direction and the day in an anti-clockwise direction
- Pull the crown to position ③ and adjust the time setting in either a clockwise or anti-clockwise direction.
- After adjusting to the correct time ensure that the crown is screwed back in until flush with the case in order that water resistance is maintained.

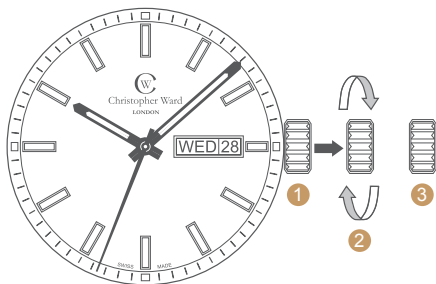

## Fitting the bracelet

If you find the bracelet needs adjusting to your wrist we recommend you have it re-sized by a reputable watch repairer or jeweller. Most local jewellers will either do this for free or perhaps make a nominal charge for what is a job that should only take a few minutes. It is always best to be present so a comfortable fit is achieved.

## Establishing the length of the bracelet

Place the watch with its separated bracelet on your wrist and estimate the number of links you need to remove. If you need to remove several links, try to keep the numbers removed from both halves of the bracelet as equal as possible to ensure that the clasp remains roughly in the middle of your wrist.



To open your bracelet simply press either side of the clasp to release as shown.

# The quick-release butterfly clasp

The strap versions of the C2 Lido use quick-release butterfly clasps. If you are unfamiliar with the butterfly clasp system just follow our 8 step guide below.



**Step 1** Locate the clasp



**Step 2** Click quick-release



**Step 3** Pull open clasp



**Step 4** Prise cover open



**Step 5** Thread strap through



**Step 6** Snap back



**Step 7** Close clasp



**Step 8** Complete



**1 ATM** (10 Metres)

Safe to wear your watch while washing your hands with tap water.



**3 ATM** (30 Metres)

Washing your car and or general hosepipe usage.



**5 ATM** (50 Metres)

Water resistant to most household shower units.



**10 ATM** (100 Metres)

Safe to use while snorkelling in open water, it is not advisable to dive with your watch.



**30 ATM** (300 Metres)

Ideal for experienced divers and, in general, anybody practising scuba-diving.



**50 ATM** (500 Metres)

Professional divers, experienced prolonged exposure underwater.

## Water resistance

Please note. these are only guidelines but we strongly urge you to adhere to them to retain the integrity of your watch. If you have any queries regarding this please contact us direct.

**NB. To safeguard watch movement please ensure the crown is, at all times, screwed in correctly.**

## Keeping in touch with Christopher Ward...

From small beginnings just a few short years ago (our first workshop was actually a refurbished chicken shed!), Christopher Ward has won a worldwide following for his eponymous watch brand and can justifiably claim to manufacture the most affordable luxury watches in the world.

For many, the philosophy behind the brand, trying to put luxury watches within the reach of everyone, is as attractive as the watches themselves as is the very open approach of the business which means that Chris and the team spend a lot of time communicating personally with our customers - many of whom have become friends.

As the owner of a Christopher Ward watch, if ever you need to get hold of us we are at your service. We have listed some useful contact details on the back cover.

There is also always something new going on at our website at **[www.christopherward.co.uk](http://www.christopherward.co.uk)** and, if you haven't already discovered the independent forum dedicated to our brand at **[www.christopherwardforum.com](http://www.christopherwardforum.com)** we would recommend a visit. Informative and fun, it's a great place to hear the unexpurgated view of Christopher Ward of London!



Christopher Ward  
LONDON

Head Office. **Christopher Ward (London) Limited, 1 Park Street, Maidenhead  
Berkshire SL6 1SL, United Kingdom**

Telephone (Head Office). **+44 (0)1628 763040**

Customer Services. **0844 875 1515 (UK) 1.877.226.8224 (USA)**

Website. **[www.christopherward.co.uk](http://www.christopherward.co.uk)**

General. **[customerservices@christopherward.co.uk](mailto:customerservices@christopherward.co.uk)**

Technical. **[technical@christopherward.co.uk](mailto:technical@christopherward.co.uk)**