

C60 Trident Pro 600

Owner's Handbook

 Christopher
Ward

Time on your side

Your Christopher Ward watch has been designed in Britain and engineered in Switzerland by highly talented craftspeople. This ensures not only accurate and precise timekeeping, but also brings a real pride of ownership that only watches of the highest quality standards can hope to deliver.

You have made an investment, a good one, and the aim of this manual is to help you make the most of that investment in what we hope will be a lifetime of ownership.

Mike France
CEO & co-founder

Welcome to the evolution

If there's a watch that epitomises the progress of Christopher Ward, look no further than the C60 Trident. Modestly introduced in 2009, the original C60 Trident Automatic was a dive watch indebted to the look and feel of the Rolex Submariner, whilst incorporating an aluminium bezel and 300m water resistance.

Yet the largest waves can start with the smallest ripples; a trickle of orders soon became a tide. The launch of a Mk 2 edition in 2015 saw a new premium Pro 600 model swap circular indexes for rectangular ones, double its water resistance and introduce a ceramic bezel into the

equation. Since then, the Trident Collection has grown exponentially – think different case materials, movements and colours – cementing itself as a cornerstone of the brand.

But it's more than just a bestseller: each update has become symbolic of the advancements made by the brand as it reaches adolescence. So when the collective minds between CW's Maidenhead and Biel HQs began to turn to the thought of a Mk 3 update, it's not an understatement to say that there was quite a pressure to make this Trident series the best one yet.

If the transition from Mk 1 from Mk 2 was a full-on revolution in both technicality and design, Trident Mk 3 takes the best elements from its predecessor and refines them further. This is an evolution rather than a revolution; and it stems from both a greater knowledge gained over the five years since the Mk 2 first surfaced, as well as the comments of our customers.

From higher quality materials – Trident Mk 3 answers the call to upgrade the lume found across our dive range – and finer levels of detail through to finessed design, they all culminate here.

With Trident Mk 3, it's the commitment to the smallest details that ultimately make the biggest impact.



C60 Trident Pro 600

How do you update the most successful CW release of all time?

It's a challenge that our Maidenhead and Biel teams could have approached with a fair degree of trepidation; but no. On the tenth anniversary of the Trident range, we saw it as an opportunity to make our bestselling watch even better.

Following customer feedback – regarding topics like legibility, for example – the C60 Trident Pro 600 Mk 3 has been comprehensively recrafted to address these; the wavy guilloche dial of old has been replaced with a shiny lacquered finish, while the quality of lume has been drastically improved. Until now a feature previously reserved for few high-end watches, the numerals and indexes of the Mk 3's zirconia ceramic bezel have also been filled with Grade X1 GL C1

Super-LumiNova®; the same lume has also been liberally applied to the dial's newly multi-faceted indexes and redesigned hands.

Elsewhere, the introduction of our signature case design, complete with slimming 'light-catcher' lines, transforms the Mk 3 into a dive watch that is both graceful and resilient. Aspects such as the action of the bezel and internal threading of the crown have been improved, ensuring that each is a pleasure to use; another subtle change arrives in the shape of our series' trident. Found upon the Mk 3's backplate and seconds hand counter-balance, its revised form is a change some may not even notice, but it's indicative of the no-stone-left-unturned approach to revisiting every aspect of this watch in the search to make it the best Trident yet.



Display and control buttons

Your C60 Trident Pro 600 has a maximum power reserve of 38 hours when fully wound. To re-power the watch after a period of non-use, simply wind the crown for approximately 20 revolutions. Normal wearing will very quickly allow the rotor to start re-powering the watch over time after putting it on your wrist.

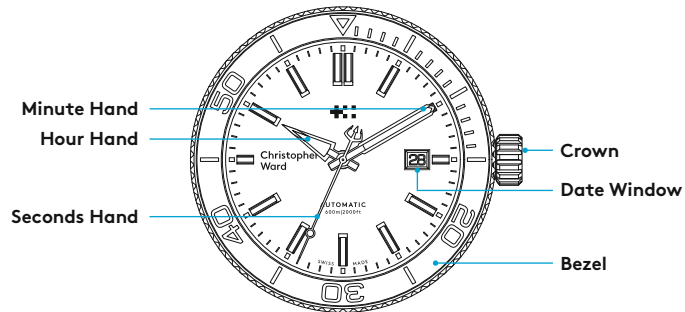

Features

- Swiss made
- Self-winding mechanical movement
- 38-hour power reserve
- Date calendar
- Central hacking seconds
- Anti-shock system
- Marine-grade, stainless steel case
- Embossed screw-in crown
- Unidirectional, polished ceramic bezel filled with Super-LumiNova®
- Anti-reflective sapphire crystal
- Black or blue polished dial
- Diamond polished and Super-LumiNova® filled indexes and hands
- Signature Trident counter-balance on seconds hand
- Screw-down deep-stamped 3D backplate
- Unique engraved serial number
- Luxury presentation case and owner's handbook
- Marine-grade stainless steel bracelet or hybrid rubber strap, both with quick release mechanism

Technical Information

Calibre	Sellita SW200
Case	Stainless Steel
Diameter	42mm, 40mm, 38mm
Weight	95g (42mm), 83g (40mm), 73g (38mm)
Water resistance	60 ATM (600 metres)
Vibrations	28,800 per hour
Timing tolerance	-20/+20 seconds per day
Dial Colour	Black or blue
Lume	Super-LumiNova® Grade X1 GL C1



Setting the time and date

For a superior water resistance your crown is of the screw-in type. The crown should sit flush to the case (position **1**) in order to maintain water resistance.

- First unscrew the crown anti-clockwise from the case to position **2** for winding in power. Wind in a clockwise direction to re-power the watch. Your C60 Trident Pro 600 has a maximum power reserve of 38 hours when fully wound. Normal wearing will allow the rotor to start re-powering the watch over time after putting on your wrist.
- Pull gently into position **3**. For rapid date correction, turn in a clockwise direction.
- Pull gently into position **4**. This position is used for handsetting and stopping of the second hand. For precise time setting it is recommended to pass beyond the desired minute and to set the hand backwards.

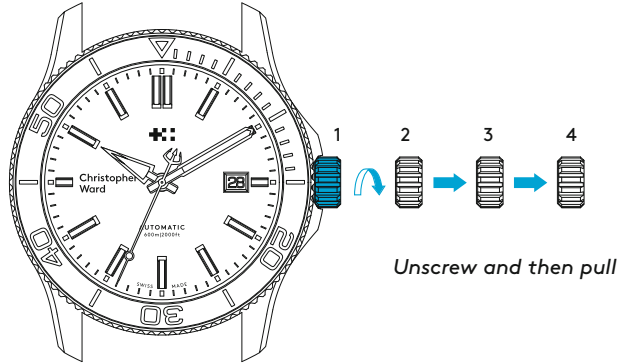

1. Crown screw-in position
2. Manual winding
3. Date setting
4. Time setting

PLEASE NOTE:

*Date correction should not be carried out between 20.00 hr and 02.00 hr as the watch gearing will already be aligning itself to change the date. The crown should always be pushed in after adjustment, and it is best to do so from position **3** to avoid advancing beyond the desired date. You must always ensure the crown is fully tightened before any use in water.*

Diving with your watch

If using the bezel for a dive and let's say the recognised maximum "no-stop time" is 55 minutes, then in this example (shown right) the time at the surface immediately before the dive is 10.10am. However the bezel marker is at the 12.00 hr position.

- Move the bezel marker anti-clockwise so that it aligns with the 10 minute position.
- You can now read that the 55 minute no decompression limit will occur at 5 minutes past the next hour.

PLEASE NOTE:

It is always useful and best practice to make a note on a dive slate before entering the water and to carry a set of dive tables should the dive plan change during the course of a dive. A safety stop for 3 to 5 minutes at 15ft is recommended at the end of all dives. A safety stop for 3 minutes at 15ft is required any time you come within 3 pressure groups of a no decompression limit, and for any dive to a depth of 100ft or deeper.

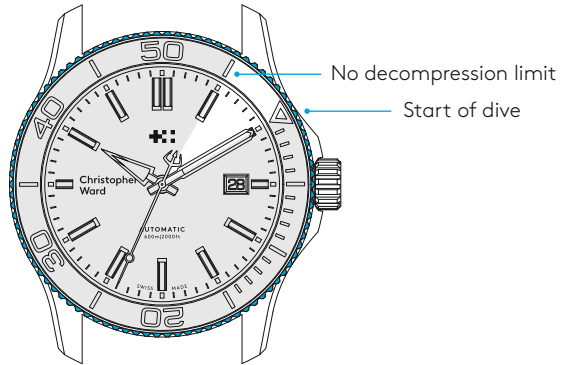
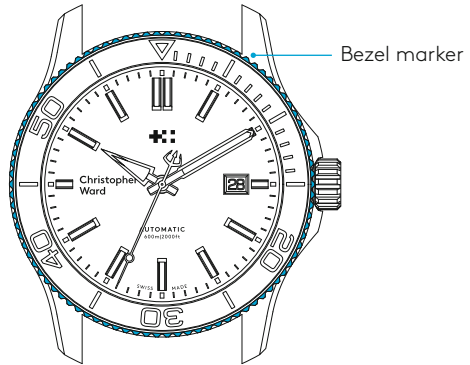

Straps and bracelets

As you would expect, we place as much emphasis on the quality of our straps and bracelets as we do our watches. We only use the finest materials in our straps, with quick-release pins also included for your convenience.

The following guidelines explain how easy it is to use, adjust and replace your Christopher Ward strap or bracelet.

Using the quick-release pins on your strap/bracelet

1. Locate the quick-release pin (or pins) on your strap (A) or bracelet (B). Pull the pin(s) inwards to detach.
2. To reattach your strap (C) or bracelet (D), pull the pin(s) inwards, and align the spring bars so that they click securely into the lug holes on each side.

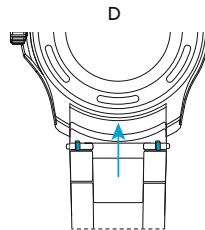
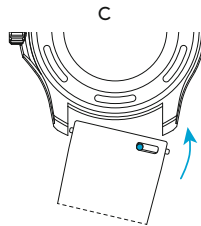
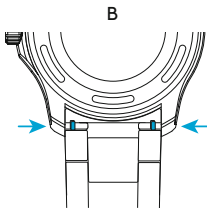
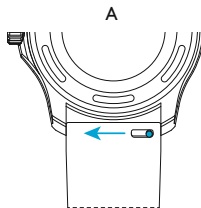

How to use the micro adjustment on your bracelet

1. Press buttons to release
2. Pull open the clasp
3. There are five micro adjustment positions, which allows for a maximum extension of 8.4mm. To extend, pull the lever to unlock and simultaneously pull on the bracelet into the desired position.
4. To shorten, simply push the bracelet back into the clasp.

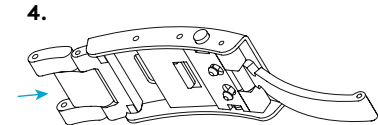
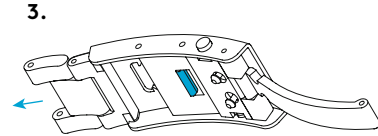
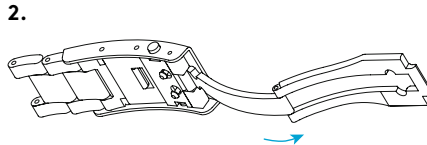
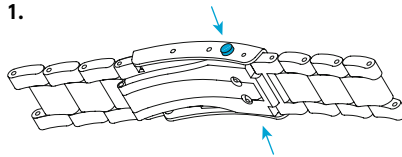

Water resistance

Although your watch has been through vigorous static pressure testing, it is worth remembering that there are many variables that can affect the water resistance of your watch. For instance, arm movements during swimming and the sudden impact of diving and water sports will drastically increase the pressure the watch is under.

Wearing your watch in the bath, shower, or sauna can also have an effect as a rapid increase in temperature can cause seals to expand and in extreme cases, malfunction or create condensation.

For these reasons, the water resistance rating of your watch (as shown) should only ever be considered a guideline and we strongly recommend they are always adhered to.



1 ATM (10 metres)

Safe to wear your watch while washing your hands with tap water



15 ATM (150 metres)

Safe to use while snorkelling in open water



100 ATM (1000 metres)

Professional deep sea diving



3 ATM (30 metres)

Washing your car and/or general hose pipe usage



30 ATM (300 metres)

Ideal for experienced divers and those practising scuba-diving



5 ATM (50 metres)

Water resistant to most household shower units



60 ATM (600 metres)

Professional divers, experiencing prolonged exposure underwater

60|60 Guarantee

Your watch is constructed from the finest components and powered by a Swiss mechanical movement. As with all quality watches, with the right care and attention, your new timepiece has the potential to become an heirloom, giving joy to future generations.

It's for this reason we've created an industry-leading approach to after-sales care, starting with our famous 60|60 Guarantee – the most comprehensive warranty in watchmaking.

60-day free returns

We hope you'll be happy with your watch from the moment it arrives. However, if that's not the case you have 60 days to return it in perfect, unused condition (with all its accompanying paperwork) in order to receive a replacement or full refund.

60-month movement guarantee

Your watch is powered by a precision-engineered Swiss movement. In the rare event that your movement develops a fault within five years we'll repair it for free under warranty. Your watch will need to be sent to us for a full diagnosis before processing a repair under warranty. We will always keep you informed before carrying out any work.

Service and repairs: the Christopher Ward way

Our approach to service and repairs is about uncompromised quality and great value for money. The process, led by our expert technicians, won't cost the earth and will have the watch back on your wrist in reasonable time. We recommend you service your watch every three to four years to keep it in peak condition.

PLEASE NOTE:

The 60|60 Guarantee does not cover accidental damage. Any service or repair by a third-party retailer will void your 60|60 Guarantee. For more details, please visit our website.

Contact us

Keeping in touch with Christopher Ward

From humble beginnings in 2004 (our first workshop was a refurbished chicken shed!) Christopher Ward has won a global following – and can justifiably claim to make the most affordable luxury watches in the world.

For many of our fans, the philosophy of trying to put luxury watches within the reach of everyone, is as smart as the timepieces themselves. This open approach sees co-founders Mike France and

Peter Ellis communicate personally with customers and listen to their feedback. Something that helps us improve our offering to you. As the owner of a Christopher Ward watch, if you ever need to get hold of us we're at your service. And if you'd like to explore the CW world more, you can follow us on social media.



@ChristopherWardLondon



@ChrisWardLondon

Head office

1 Park Street, Maidenhead,
Berkshire SL6 1SL
United Kingdom

Customer support

UK and EU Tel: +44 (0)1628 763040
US Tel: +1 (877) 380 2288
ROW Tel: +1 (877) 380 2288
customerservices@christopherward.co.uk
technical@christopherward.co.uk

christopherward.com

