

C7 Rapide
Chronograph COSC

Limited Edition

Owner's handbook

**Christopher
Ward**

Time on your side...

Your Christopher Ward watch has been designed and engineered by highly talented craftspeople to ensure not only accurate and precise timekeeping but also to bring a real pride of ownership that only items of the highest quality can ever hope to deliver.

You have made an investment, a good one, and the aim of this handbook is to help you make the most of that investment during what I hope will be a lifetime of ownership.



Christopher Ward

Contents

C7 Rapide Chronograph COSC Limited Edition	2-3
Technical information	4-5
How to operate your C7 Rapide Chronograph COSC	6-14
Our watch care programme	15
Keeping in touch	16

C7 Rapide Chronograph COSC

The date is September 5, 1971, and the ninth race of the 1971 World Championship is taking place at Monza, just north of Milan. A simplistic track layout characterised by many straight sections and a notable lack of slow corners or chicanes, the 1971 Italian Grand Prix broke the record for the fastest average speed at the time (only broken some 32 years later, coincidentally at the very same circuit).

However, the race holds a record that remains to this day. Peter Gethin, a driver for the British Racing Motor company, found himself in fourth spot as he entered the final lap (and third on the final corner), yet by the next time he'd crossed the finish line, he had won the only Grand Prix of his career – by 0.010 of a second!

Sure, we haven't seen a finish that close since, and we've now progressed into an era where results are tracked digitally; but the C7 Rapide Chronograph COSC is a watch that deals with the levels of accuracy required that day. Powered by a thermo-compensated quartz chronometer (ensuring timekeeping of ± 10 seconds a year) with a chronograph subdial that can track hundredths of a second, the C7 offers world-class precision.

Featuring the stainless steel and aluminium four-piece case that was developed solely for our motorsport collection, the C7 Rapide Chronograph COSC is limited to 500 pieces. It's an essential wear for days at the racetrack – not only will it impress with its bold blue dial design, but you'll have the quiet satisfaction of knowing your watch far exceeds anybody else's in the paddock for accuracy!



Technical information

Features

- Swiss made
- Limited edition of 500 pieces
- 27 jewel quartz chronograph chronometer
- Hour, minute, small second, date, centre stop second (1/1 sec), 60 minute counter, 12 hours counter, tenths second counter
- 316L stainless steel and blue aluminium four-piece case
- Tri-compax dial layout with sunray finish subdials
- Aluminium bezel with 5 minute markers
- SuperLuminova® indexes
- Anti-reflective flat sapphire crystal
- Screw-in crown
- Deep-stamped screw-down backplate with unique engraved serial number

Technical

Diameter:	42mm
Height:	11.55mm
Weight:	71g
Calibre:	ETA 251.264 BD PRD (PreciDrive and PowerDrive)
Case:	316L stainless steel and aluminium
Water Resistance:	10 ATM (100 metres)
Timing tolerance:	±10 secs per year
Lug to lug:	48.2mm
Strap:	22mm



Setting the time and date



1. Crown screw-in position
2. Unscrewed position
3. Date setting
4. Time setting

Unscrew and then pull out

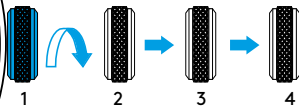

For a superior water resistance your crown is of the screw-in type. The crown should sit flush to the case (position **1**) in order to maintain water resistance.

- First unscrew the crown anti-clockwise from the case to position **2**.
- To advance or reverse the date, pull out the crown into position **3**. Turn in a clockwise direction to advance the date, anti-clockwise to reverse the date (please note the hour hand will jump in incremental steps). Once the hour hand passes 12 o'clock, the date wheel will jump forwards or backwards based on the direction used. Please note that the date wheel cannot be changed independently.
- Pull gently into position **4**. This position is used for handsetting and stopping of the second hand. For precise time setting it is recommended to pass beyond the desired minute and to set the hand backwards.

PLEASE NOTE: You must always ensure the crown is fully tightened before any use in water.

Using the chronograph

Start

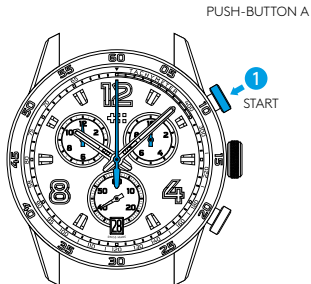

Press push-button A to start timing.

PLEASE NOTE: Before starting the time, reset the chronograph hands to their original position. See the **Reset** section to set the counters to zero.

Stop



To stop the timing, press push-button **A** once more and read the 12 hour counter, 60 minutes counter, 60 seconds counter and 1/10 second counter. For example: 5 mins, 57 seconds and 7/10 second.

Restart/Stop



To restart the timing, press push-button **A** again (timing is resumed).

To stop timing press push-button **A** and read the 4 chronograph hands. For example: 3 hours, 20 mins, 3 seconds and 4/10 second.

Reset

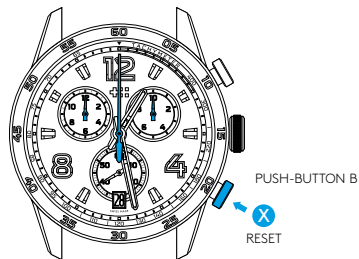

To reset the timing, press push-button **B** (The 4 chronograph hands will be reset to their zero positions).

Adjusting chronograph hands to zero position

One or several chronograph hands are not in their correct zero positions and have to be adjusted (e.g. following a battery change).

Adjusting the hour and minutes chronograph hands

Pull out the crown to position 3.
Press Button **A** to adjust the hour chronograph hand and Button **B** to reset the 60 minute counter to zero.

Adjusting the stop second and tenths seconds hands

Pull out the crown to position 4.
Push Button **A** to adjust the stop second hand and Button **B** to adjust the tenths seconds hand.

When chronograph hands have been reset, return the crown to position 2 and screw-in to position 1.

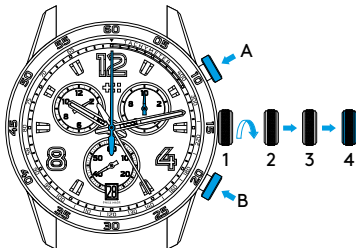
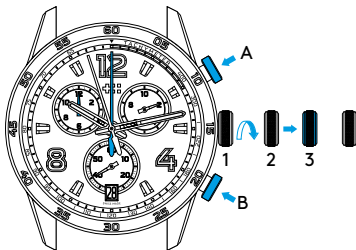



Straps and bracelets

As you would expect, we place as much emphasis on the quality of our straps and bracelets as we do our watches. We only use the finest leathers for our straps. Similarly, we only use the finest metals in the construction of our bracelets, all of which are precision engineered for durability, efficiency and comfort.

The following guidelines explain how easy it is to use and adjust your Christopher Ward strap or bracelet.

Using the quick-release pins on your strap

1. Locate the quick-release pin on your strap. Pull the pin to the side to detach your strap.

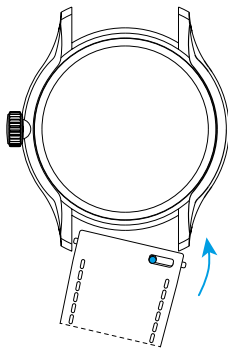
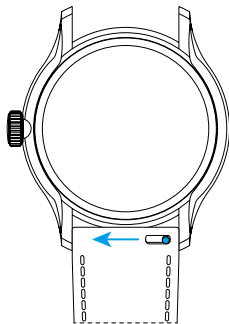

2. To reattach your strap, align the pins to the lug holes and click the strap into position. Repeat for the other side.

Integrated bracelet with micro adjustment

1. Press buttons to release.

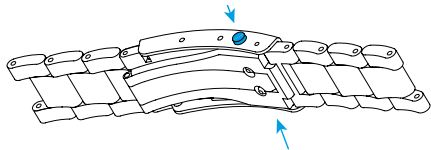

2. Pull open the clasp.

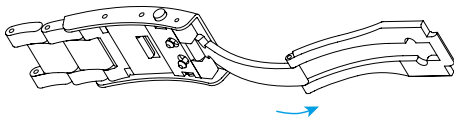

3. There are five micro adjustment positions, which allows for a maximum extension of 8.4mm. To extend, pull the lever to unlock and simultaneously pull on the bracelet into the desired position.

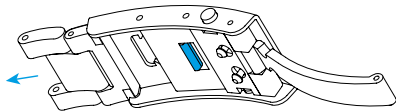

4. To shorten, simply push the bracelet back into the clasp.

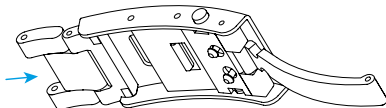

Water resistance

Although your watch has been through vigorous static pressure testing, it is worth remembering that there are many variables that can affect the water resistance of your watch.

For instance, arm movements during swimming and the sudden impact of diving and water sports will drastically increase the pressure the watch is under. Wearing your watch in the bath, shower, or sauna can also have an effect as a rapid increase in temperature can cause seals to expand and in extreme cases, malfunction or create condensation.

For these reasons, the water resistance rating of your watch (as shown) should only ever be considered a guideline and we strongly recommend they are always adhered to.



1 ATM (10 metres)

Safe to wear your watch while washing your hands with tap water.



3 ATM (30 metres)

Washing your car and/or general hose pipe usage.



10 ATM (100 metres)

Water resistant to most household shower units.



15 ATM (150 metres)

Safe to use while snorkelling in open water.



30 ATM (300 metres)

Ideal for experienced divers and those practising scuba-diving.



60 ATM (600 metres)

Professional divers, experiencing prolonged exposure underwater.



100 ATM (1000 metres)

Professional deep sea diving.

Our watch care programme

Your watch is constructed from the finest components and materials available including one of Switzerland's finest mechanical movements. As with all watches of this quality, with the right care and attention, your new Christopher Ward watch has the potential to become an heirloom piece giving further joy to future generations. It's for this reason we have created our industry leading approach to after-sales care, starting with our famous 60|60 Guarantee which remains the most comprehensive guarantee in the world of watchmaking.

Visit our website for more details about our 60|60 Guarantee and Service and Repair Programme.

60|60 Guarantee

1. 60 Day free returns

Our success depends on you being completely happy with your new Christopher Ward watch. You have up to 60 days to return your watch, absolutely free of charge, and receive a replacement or full refund by return – so long as it has not been worn and is returned in perfect condition.

2. 60 Month movement guarantee

Your watch, at its heart, has a top quality precision engineered Swiss movement – so it's very unlikely to give you problems with the minimum amount of care and attention, including a regular service. We recommend you return your watch to us every 3/4 years for a service, so our expert technicians can keep your fine timepiece in peak condition.

Servicing and repairs...the Christopher Ward way...

Our innovative approach to servicing and repairing your Christopher Ward watch means that having your watch serviced or repaired doesn't mean months of waiting followed by an exorbitant bill – which is more or less the experience guaranteed by every other luxury watch brand. We have developed an easy, quick and affordable expert service and repairs programme that doesn't cost the earth and has your watch back where it belongs – on your wrist – in double-quick time.

Keeping in touch with Christopher Ward

From small beginnings just a few short years ago (our first workshop was actually a refurbished chicken shed!), Christopher Ward has won a worldwide following for his eponymous watch brand and can justifiably claim to manufacture the most affordable luxury watches in the world.

For many, the philosophy behind the brand, of trying to put luxury watches within the reach of everyone, is as attractive as the watches themselves, as is the very open approach of the business which means that Chris and the team spend a lot of time communicating personally with our customers – many of whom have become friends.

As the owner of a Christopher Ward watch, if ever you need to get hold of us we are at your service. We have listed some useful contact details on the back cover.

There is also always something new going on at our website at **www.christopherward.co.uk** and, if you haven't already discovered the independent forum dedicated to our brand at **www.christopherwardforum.com** we would recommend a visit. Informative and fun, it's a great place to hear the unexpurgated view of Christopher Ward.



Head Office

1 Park Street, Maidenhead,
Berkshire SL6 1SL
United Kingdom

Customer Services

UK: +44 (0)1628 763040
USA: +44 (0)1.877.226.8224
customerservices@christopherward.co.uk
technical@christopherward.co.uk

christopherward.co.uk